

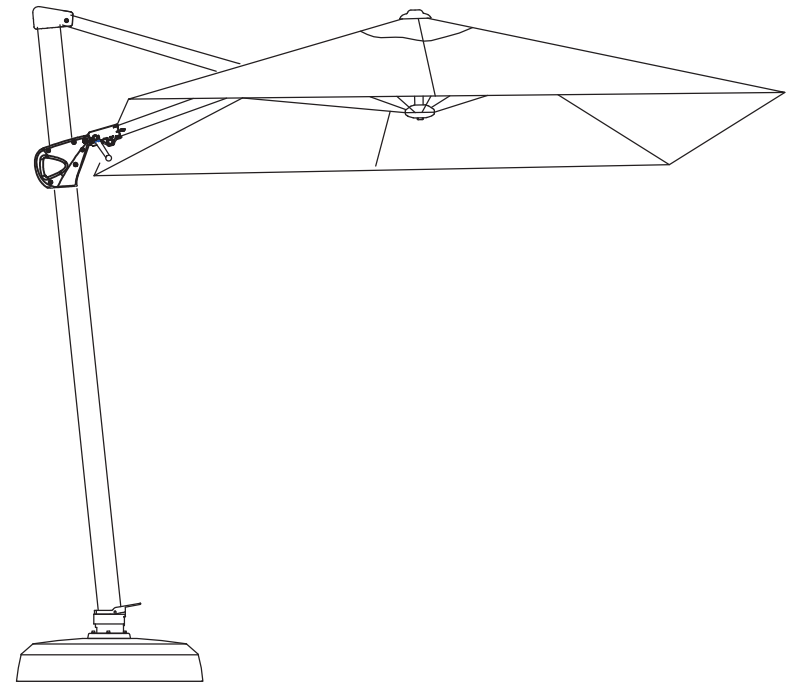

**3 M / 10 FT SQUARE CANTILEVER PATIO  
UMBRELLA WITH BASE  
ITM. / ART. 1500086 / 1500295  
ASSEMBLY INSTRUCTIONS**  
**IMPORTANT, RETAIN FOR FUTURE REFERENCE: READ CAREFULLY**



For customer service in the US and Canada, call: 1-877-730-1583,  
9:00AM - 5:00PM EST, Monday – Friday, English and French spoken,  
or visit [www.proshade.com](http://www.proshade.com).

**NOTE: PARTS SHOWN ON PART LIST ARE NOT TO SCALE**

	PARTS LIST		DESCRIPTION	QTY
A			Frame and Canopy	1
B			Rotation Part	1
C			Umbrella Cover (with 3pcs support rod)	1
D			Crank	1
E		M8*25	Bolts and Washer	2
F		6#	Allen Wrench	1
G		2.5#	Allen Wrench	1
H			Operation Manual	1
I			Inverted Base Stem	1
J			Tube	1

\* Parts A-J are packed in box 1 of 2.

K			Steel Wrench	1
L		M8*22	Bolts and Washer	4
M		M8*23	Screw	4
N		5#	Allen Wrench	1
O			Base	1

\* Parts K-O are packed in box 2 of 2.

<p>DISTRIBUTED BY: COSTCO WHOLESALE CORPORATION P.O. BOX 34535 SEATTLE, WA 98124-1535 USA 1-800-774-2678 WWW.COSTCO.COM</p>	<p>IMPORTED BY / IMPORTÉ PAR : COSTCO WHOLESALE CANADA LTD.* 415 W. HUNT CLUB ROAD OTTAWA, ONTARIO K2E 1C5, CANADA 1-800-463-3783 WWW.COSTCO.CA * faisant affaire au Québec sous le nom Les Entrepôts Costco</p>	<p>IMPORTADO POR: IMPORTADORA PRIMEX S.A. DE C.V. BLVD. MAGNOCENTRO NO. 4 SAN FERNANDO LA HERRADURA HUIXQUILUCAN, ESTADO DE MEXICO C.P. 52760 RFC: IPR-930907-S70 (55)-5246-5500 WWW.COSTCO.COM.MX</p>
<p>DISTRIBUTED BY: COSTCO WHOLESALE ICELAND EHF. KAUPTUN 3-7, 210 GARDABAER ICELAND WWW.COSTCO.IS</p>	<p>IMPORTED BY: COSTCO WHOLESALE AUSTRALIA PTY LTD 17-21 PARRAMATTA ROAD LIDCOMBE NSW 2141 AUSTRALIA WWW.COSTCO.COM.AU</p>	<p>IMPORTED AND DISTRIBUTED BY: COSTCO WHOLESALE KOREA, LTD. 40, ILJIK-RO GWANGMYEONG-SI GYEONGGI-DO, 14347, KOREA 1899-9900 WWW.COSTCO.CO.KR</p>
<p>IMPORTADO POR: COSTCO WHOLESALE SPAIN S.L.U. POLIGONO EMPRESARIAL LOS GAVILANES C/ AGUSTIN DE BETANCOURT, 17 28906 GETAFE (MADRID) ESPAÑA NIF: B86509460 900 111 155 WWW.COSTCO.ES</p>	<p>IMPORTED BY: COSTCO WHOLESALE UK LTD / COSTCO ONLINE UK LTD HARTSPRING LANE WATFORD, HERTS WD25 8JS UNITED KINGDOM 01923 213113 WWW.COSTCO.CO.UK</p>	<p>IMPORTED BY / MANUFACTURED FOR: COSTCO PRESIDENT TAIWAN, INC. NO. 656 CHUNG-HWA 5TH ROAD KAOHSIUNG, TAIWAN COMPANY TAX ID: 96972798 0800-885-889 WWW.COSTCO.COM.TW</p>
<p>IMPORTED BY: COSTCO WHOLESALE JAPAN LTD. 3-1-4 IKEGAMI-SHINCHO KAWASAKI-KU, KAWASAKI-SHI, KANAGAWA 210-0832 JAPAN 044-281-2600 WWW.COSTCO.CO.JP</p>		
<p>DISTRIBUÉ PAR: COSTCO FRANCE 1 AVENUE DE BRÉHAT 91140 VILLEBON-SUR-YVETTE FRANCE 01 80 45 01 10 WWW.COSTCO.FR</p>		

**More information at [www.proshade.com](http://www.proshade.com)**

**MADE IN CHINA / FABRIQUÉ EN CHINE/ HECHO EN CHINA**

**CARE INSTRUCTION:**

- **FRAME:** To clean, use a mild detergent and warm water on the frame.  
Do not use abrasive materials or cleaners.
- **CANOPY:** Wash with a mild solution of soap and water.  
Rinse thoroughly and drip-dry in an open position.

**CAUTION:**

- Place the base in the desired location for use before filling with sand and water.  
After filling with sand and water, base is not easy to move.
- To avoid personal injury or damage to the umbrella, make sure the area around you is clear from any outdoor structure or furniture.
- Keep all flame and heat sources away from this umbrella.

## 3 M / 10 FT SQUARE CANTILEVER PATIO UMBRELLA WITH BASE

### LETTER OF WARRANTY

ITM. / ART.1500086 / 1500295

Please be advised that the manufacturer provides a one-year warranty that this product will be free from defects in original materials and workmanship for 3 m / 10 ft Square Cantilever Patio Umbrella with Base.

#### Frame

Frames are warranted to be free from defects in materials and workmanship for a period of one year. Damage to frames or welds due to improper assembly or exposure to water and sub-freezing temperatures is not covered. Do not allow water to accumulate inside frames.

#### Finish

The finish is warranted against peeling, cracking, or blistering for a period of one year, provided the unit has not been scratched or abraded. Scratches and chips resulting from abnormal wear and tear are not covered. Fading resulting from exposure to elements is not covered.

#### Fabric

Fabric is warranted for a period of one year against separation at the seams. Fading or discoloration resulting from exposure to the elements, chemicals, or from spills is not covered.

**Note:** All operation should be according to the instruction manual.

\* This warranty DOES NOT COVER the following items:

Failure caused by unreasonable or abusive use; failure caused by neglect of reasonable and necessary care; acts of nature (including but not limited to wind, hurricanes, tornadoes, and storms) are not covered by this warranty. *The product is not covered by this warranty after one year from the date of purchase.*

AUSTRALIA: Our goods come with guarantees that cannot be excluded under the Australian Consumer Law. You are entitled to a replacement or refund for a major failure and for compensation for any other reasonably foreseeable loss or damage. You are also entitled to have the goods repaired or replaced if the goods fail to be of acceptable quality and the failure does not amount to a major failure.

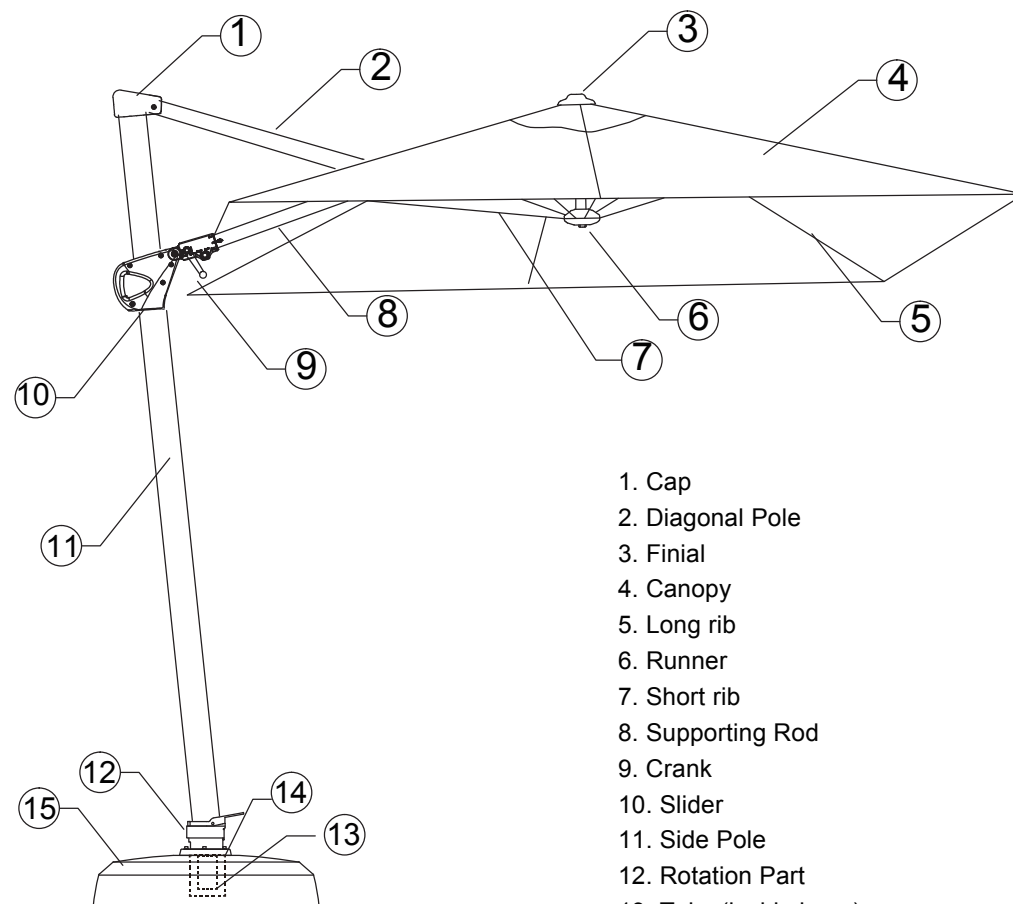

1. Cap
2. Diagonal Pole
3. Finial
4. Canopy
5. Long rib
6. Runner
7. Short rib
8. Supporting Rod
9. Crank
10. Slider
11. Side Pole
12. Rotation Part
13. Tube (inside base)
14. Inverted Base Stem
15. Base

## ASSEMBLING THE BASE

1

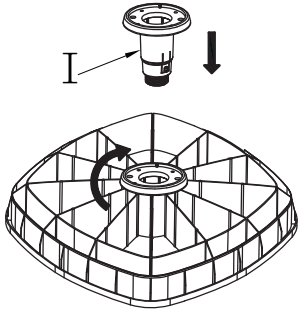

- Insert the stem.

2

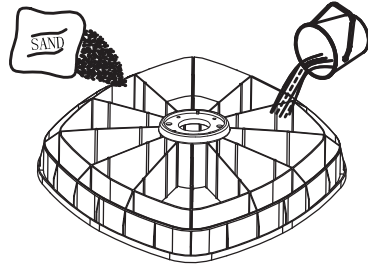

- Fill base with sand and then add water to wet the sand.  
The total weight of whole set base is recommended to reach 320 lb / 145.5 kg.

3

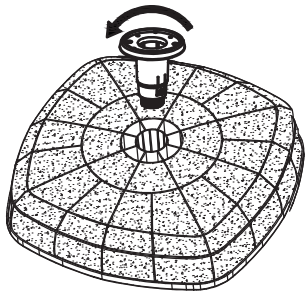

- Remove the stem.

4

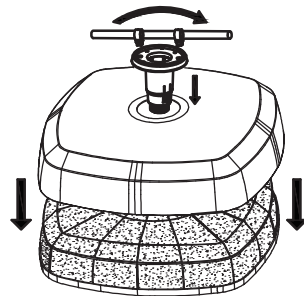

- Reinstall base cover and stem.  
Do not overtighten stem, or parts may be damaged.

## UMBRELLA COVER

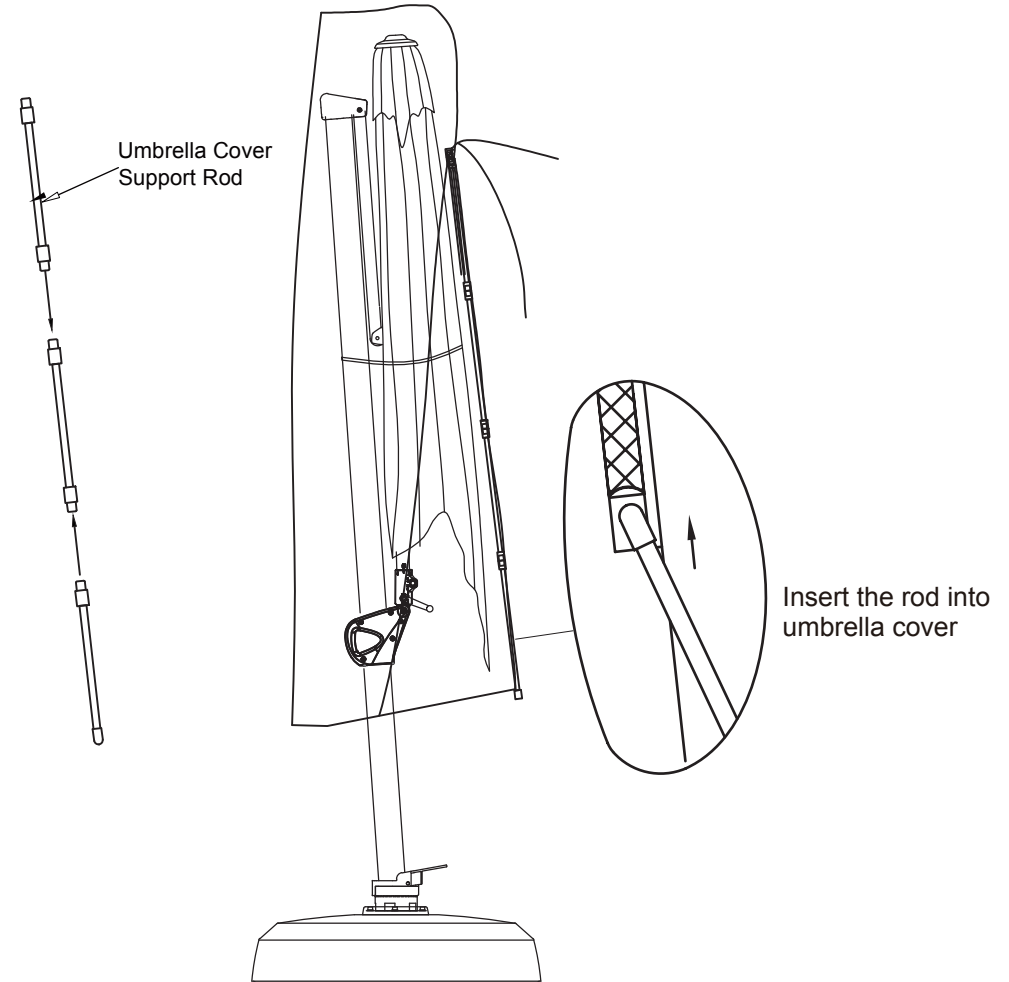

### **Caution:**

- Umbrella cover should only be used when umbrella fabric is completely dry.
- Umbrella should be closed or stored indoors during windy conditions.
- Do not use during windy or severe weather conditions.

## UMBRELLA LIGHT INSTALLATION

(UMBRELLA LIGHT IS NOT INCLUDED)

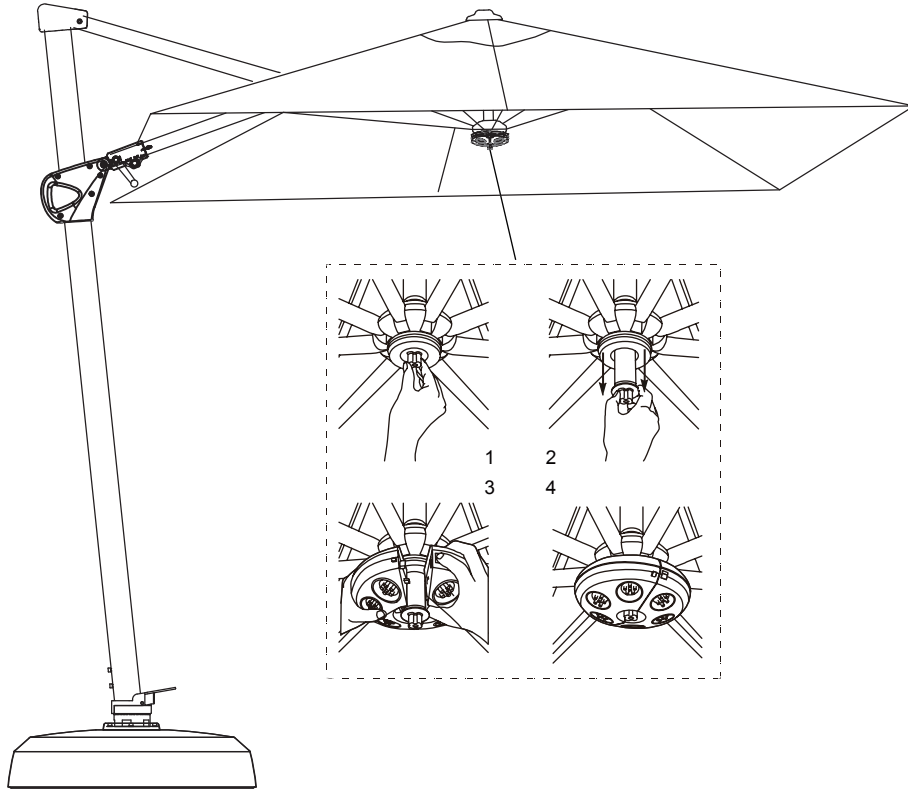

## ASSEMBLING THE BASE

5

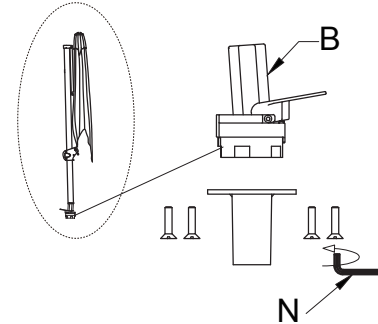

- Connect the rotation part with tube.

6

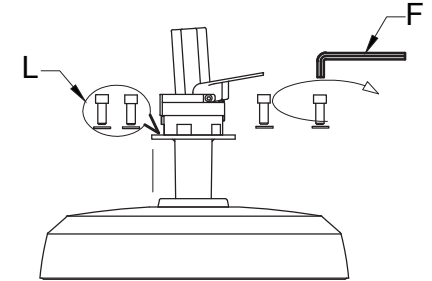

7

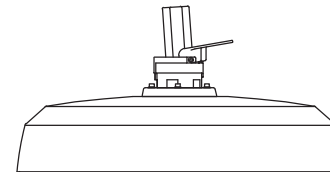

- Connect the rotation part with tube.

8

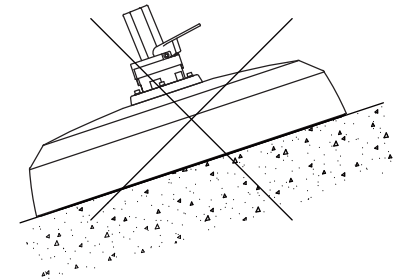

### Caution:

- Remove the stem carefully (step 3) to avoid sand getting into the center of the base shell. Fill the base completely with 90 kg / 200 lb sand, then add water to wet down the sand.
- Only use the base provided with this umbrella. Other bases may not fit with this umbrella and could cause a safety issue. Make certain the base is securely placed on flat surface before inserting the umbrella.

## ASSEMBLING THE UMBRELLA

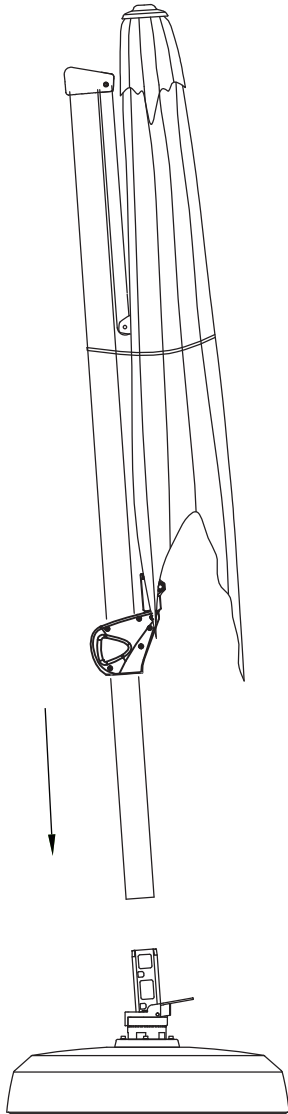

- Use 2 people to put the umbrella on the rotation part

## ROTATING THE UMBRELLA

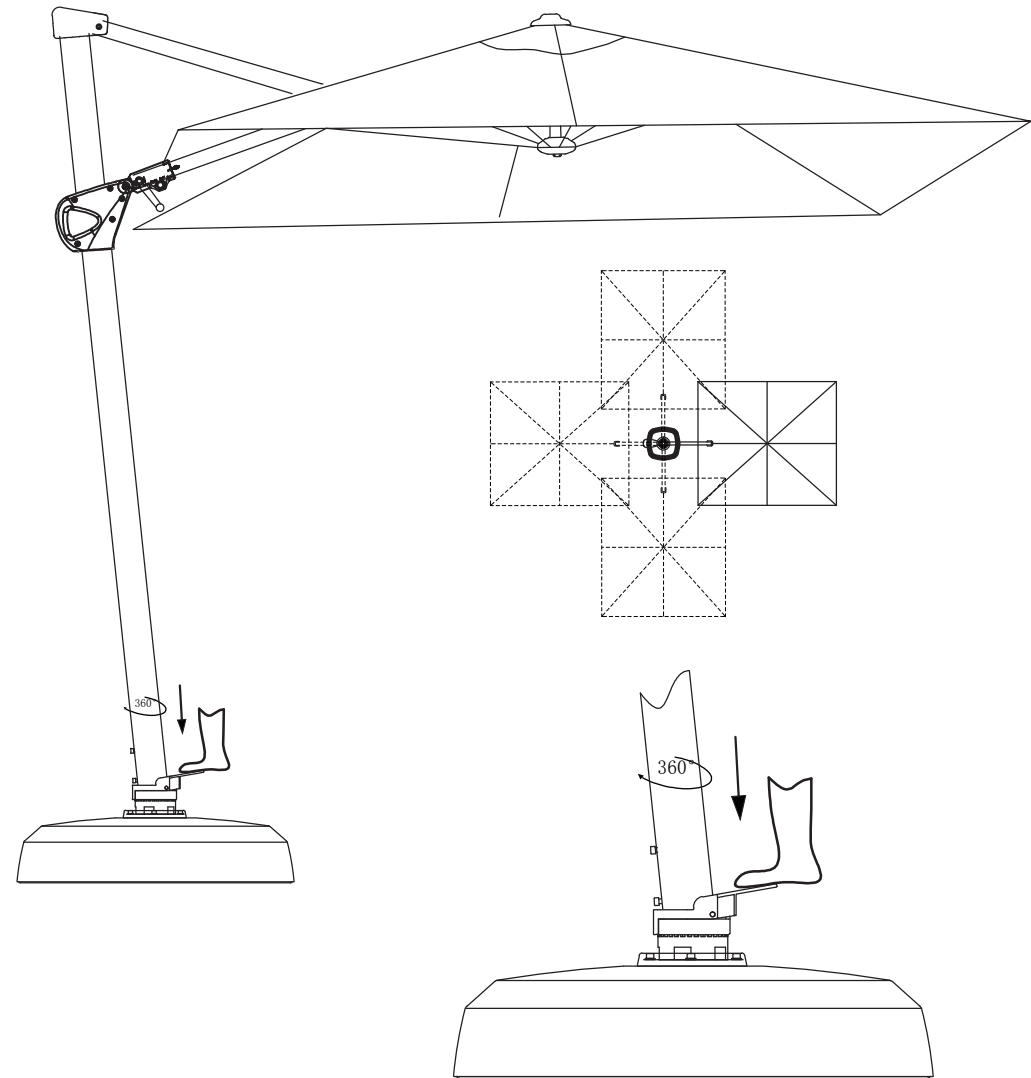

- Step on the pedal of the rotation part. Turn the pole to your desired position and then release the pedal.

## OPERATING THE UMBRELLA

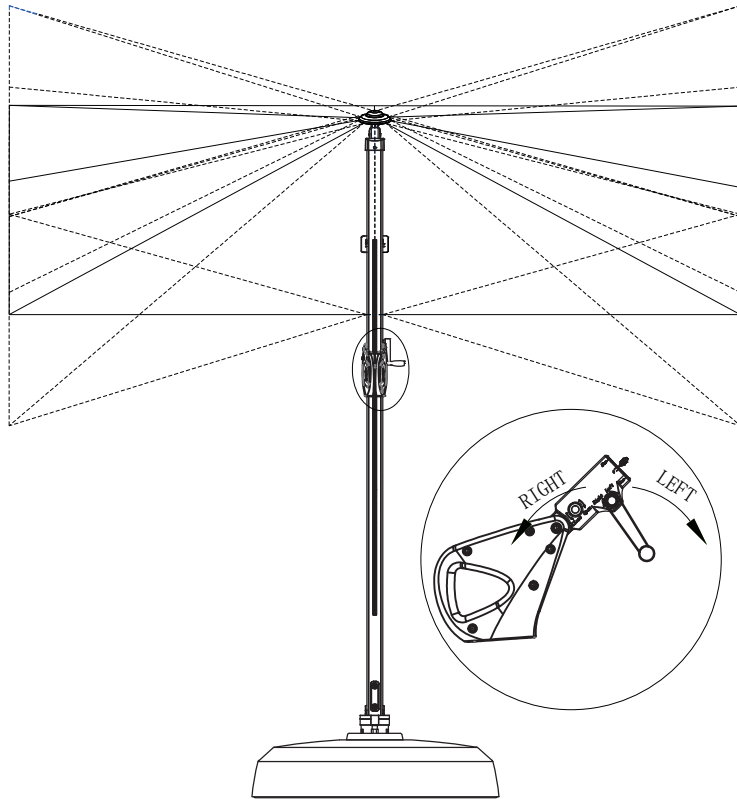

- Insert the crank into the tilt socket. Turn the crank clockwise or counter-clockwise to tilt the canopy.
- Please note that the umbrella catches more wind when tilted and so the tilt feature should be used with extreme caution

## ASSEMBLING THE UMBRELLA

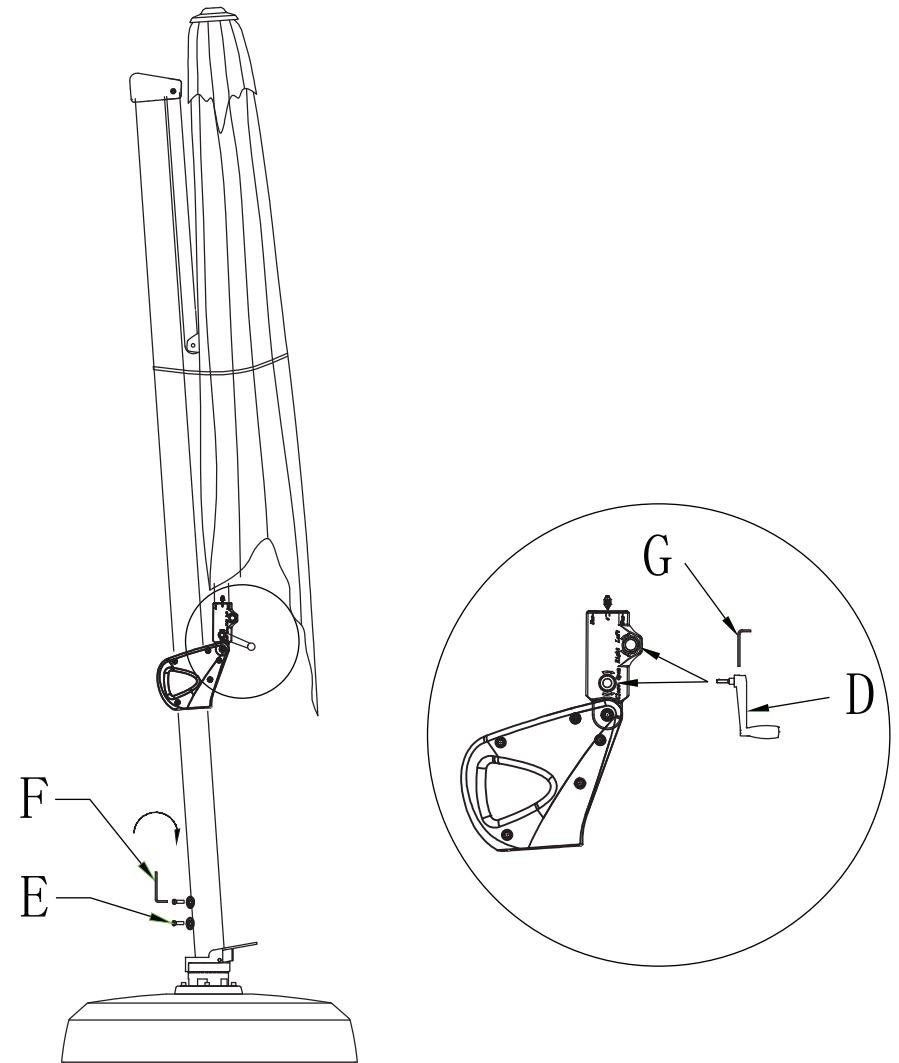

- Secure the umbrella with screws using the included allen wrench (F). Fix the crank by allen wrench (G).

## OPERATING THE UMBRELLA

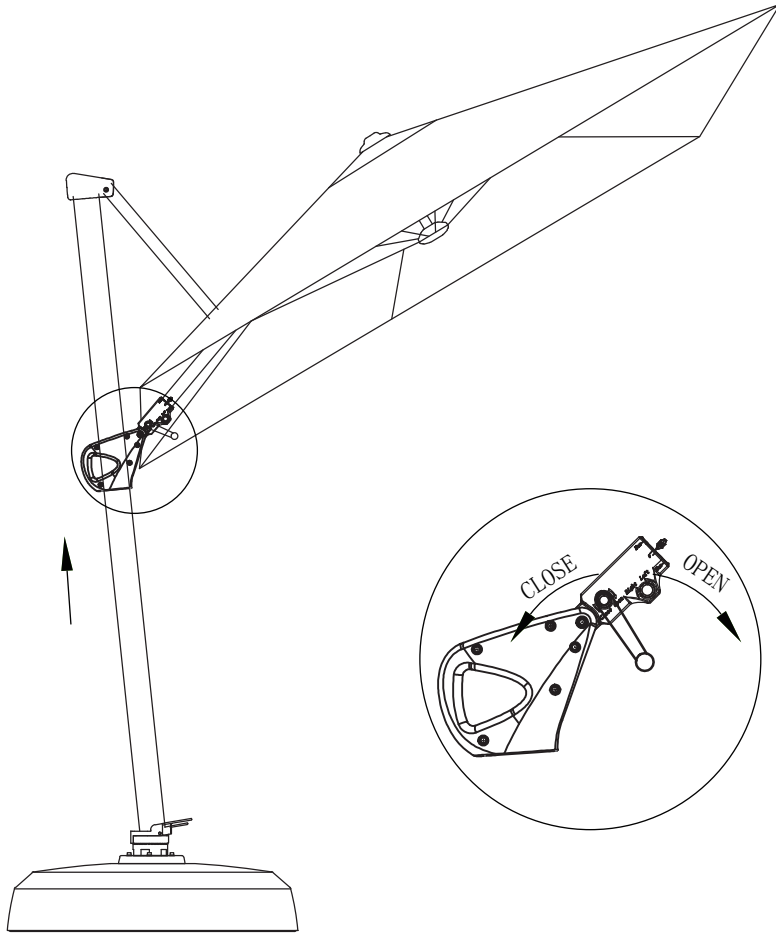

- Move up the slider a bit.  
Turn the crank clockwise to open the umbrella, and turn the crank counter-clockwise to close.

## OPERATING THE UMBRELLA

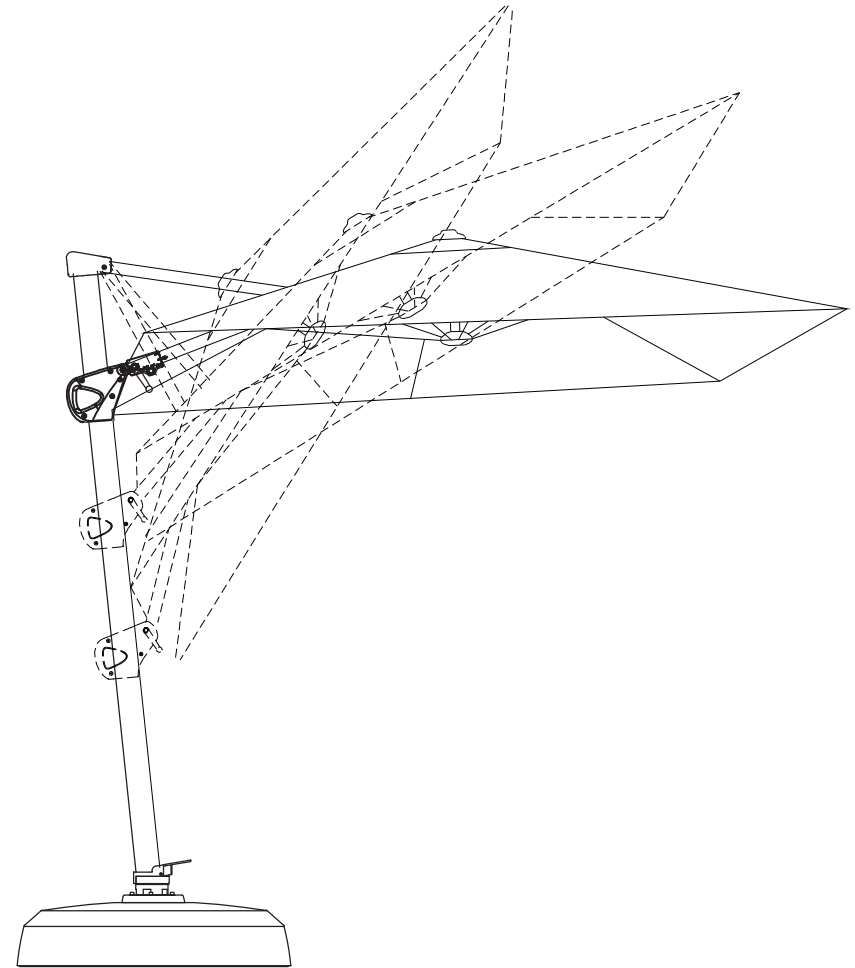

- When the umbrella is fully opened, move the slider to tilt the umbrella to your desired position.