

Power Pet Door®

INSTALLATION & OPERATING INSTRUCTIONS

1. INTRODUCTION:

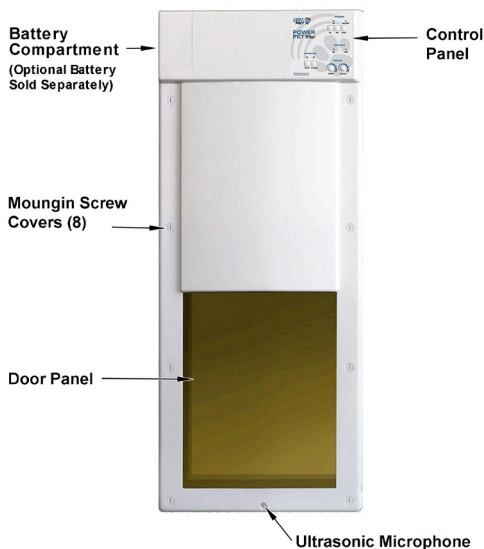

Product Description:

Your new POWER PET Electronic Pet Door is like no other pet door made. Genuine POWER PET® electronic pet doors are fully automatic, motor driven and open completely under their own power. Activated by an ultrasonic pet collar, your new POWER PET door will keep out stray animals. It is secure against wind, rain, cold and snow and provides much better insulation than a conventional flap

door. Your new POWER PET door features an attractive, high-strength door panel that quickly and quietly powers upward disappearing into the stylish housing. Your pets are empowered to come and go as they please while their animal friends are politely asked to stay out.

POWER PET doors increase home security with a special automatic, dead bolt locking feature that guards against would-be intruders. Only the coded Signal from your pet's collar will open the Power Pet door.

Only Power Pet doors feature an ingenious directional sensing system that operates a fully automatic, motor driven panel. The signal emitted from your pet's collar tells the Power Pet door how far away your pet is and the direction in which your pet is traveling. This allows the Power Pet to work like magic, opening only when your pet is on a direct approach, not when it is just wandering by and not when it is sitting or sleeping next to the door.

BASIC PET DOOR OPERATION:



Your POWER PET door uses our Patented directional ultrasonic sensing system. This system has great advantages over magnetic or radio transmitter collars.

Magnetic collars have a very limited range making it tough to train the pet to operate the door. Radio systems have good range but open whenever the animal is within that range, even if the pet is sitting, sleeping or just wandering by.

The Power Pet's directional ultrasonic system overcomes these problems. The

Pet worn ultrasonic collar emits a highly directional signal, which is received by the microphone only when your pet is directly facing the door opening. The unit is not likely to trigger if your pet is just wandering by.

2. INSTALLING YOUR POWER PET DOOR

Your POWER PET door package includes:

- (3) Pet Transmitter Collars (Model MS-5 Rugged Ultrasonic Transmitter Collar)
- 110 volt AC Adapter
- CRG-12V-2B Rechargeable Battery Kit
- (12) B-3V1A Batteries (For Your MS-5 Collars)
- Outside Bezel
- All Required Hardware

(Wall Adapter Tunnel, is sold separately.)

Your POWER PET door mounts flush to any door or wall. The hardest



part of installing the POWER PET door is cutting the hole. If the unit is to be mounted in a door up to 1 3/4" thick there is no framing necessary. The pre-made Outer Frame that came with your POWER PET door will provide a finished look to the opening. If you are installing your POWER PET door in a wall, it is

advisable to build a frame around the opening or order our convenient WALL ADAPTER TUNNEL. The hole dimensions given below are for the finished opening not including the frame. Dimensions of the frame you build should be added to the opening size to determine the final size of the hole you cut in your wall.

POSITIONING THE OPENING ON DOOR OR WALL:

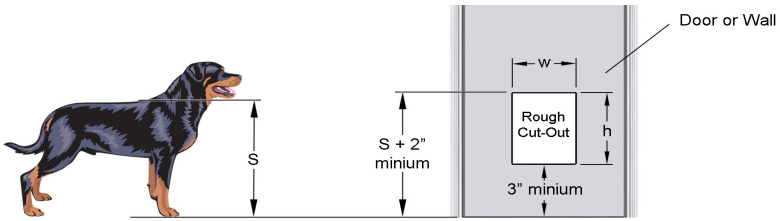

osition rough cut-out 2 inches above shoulder height or 3 inches above floor, which ever is higher.

Note: If you have multiple pets of different sizes use the positioning method above based upon the size of your largest pet.

CUT-OUT DIMENSIONS:

Rough Cut-Out Dimensions		
Size	w	h
PX-1 (Medium)	8 7/8"	11 1/4"
PX-2 (Large)	12 7/8"	17 1/4"

FRAMING THE OPENING

To frame your opening we highly recommend you purchase the optional Wall Tunnel which will make framing easy for a professional quality job. If you choose to make your own frame, note that the rough opening dimensions apply to the inside dimensions of your frame as shown below.

Model PX-1

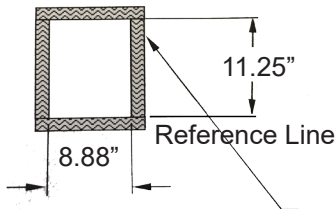

Model PX-2

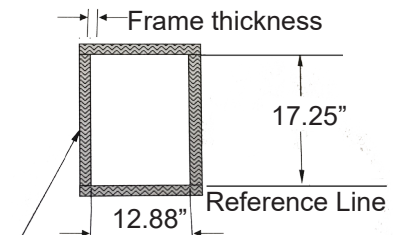

Final cut out size should include the thickness of any additional wall framing (not required for door mount or when using optional wall mount kit)

MOUNTING YOUR POWER PET DOOR

This is the easy part. Install the POWER PET and Outside Frame as shown below.

1. Cut Hole (wall installations will require framing)

2. Install Power Pet door

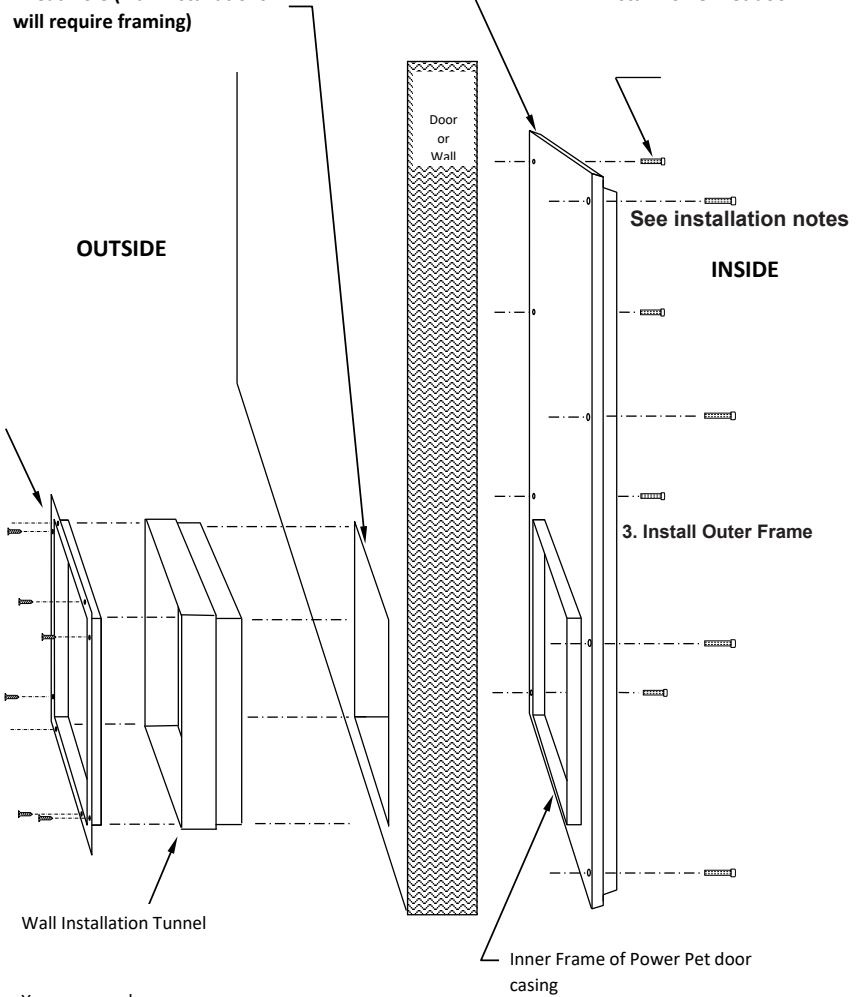

You may purchase our optional WALL ADAPTER TUNNEL Or build your

IMPORTANT INSTALLATION NOTES:

1. When installing the inside mounting screws, make sure they are only moderately tight. Over tightening will cause your Power Pet door housing to conform to any irregularities in the flatness of your door or wall and will cause the door panel to slow, stick or malfunction. Do not use a power screwdriver. Use a manual screw driver to tighten the screws until they stop. That is enough to ensure that the installation is secure. Should your door panel malfunction during the initial power up, loosen each mounting screw and re-test.
2. Note that screw covers (not pictured) are provided to finish the screw holes. Once installed, the screw covers on the inside unit may be removed by twisting **CLOCKWISE** using a coin or flat head screwdriver. Twisting counter-clockwise will cause the screw covers to break. Screw covers on the outside bezel may be removed by prying off with a knife blade or thin flat object.

3. POWER PET DOOR OPERATION:

INTRINSICALLY SAFE OPERATION

The POWER PET electronic pet door is intrinsically safe. It uses an electric motor and cable drive to lift the door panel. The panel remains open until the pet collar signal is gone, indicating that your pet is clear of the opening. When the pet collar signal is gone, power to the motor is turned off and the panel is returned by the force of gravity only. Downward speed is reduced by an electronic brake applied to the reverse motion of the motor. This brake operates with or without electrical power. Because the panel is returned by simple gravity, the maximum force that can be applied by the panel when it is closing is limited to its own weight. The door panel weighs only about 2 lbs.

AUTO RETRACT FEATURE

As an added safety feature, the POWER PET also has a sensing system that automatically raises the panel should it encounter an obstruction on the way down. This feature can be defeated in the unusual case that binding or other restriction slows the door closure to the point that it unnecessarily retracts. See the **AUTOMATIC SAFETY RETRACT** Section below for more information.

AUTO DEAD BOLT LOCKING FEATURE

As shown in Figure 7, the POWER PET door uses a spring loaded locking pin which automatically snaps into its retaining hole when the movable panel comes to rest in the closed position. The pin can only be released when the motor applies tension to the cable. This makes it impossible for even the most clever animals (and people) to raise the panel mechanically.

THREE DIFFERENT POWER CHOICES: Your new **POWER PET®** Door may be operated in three different power modes.

- 110 volt AC Wall Outlet:** Your standard **POWER PET™** Door comes standard with a U.L. approved ac adapter. Plug the adapter into a nearby wall outlet for continuous operation.
- AC with Battery Back-up:** You may purchase an optional rechargeable battery for use along with your ac adapter. If your household electricity should ever fail, your **POWER PET™** Door will automatically switch over to battery operation. When power is restored, the ac adapter will automatically recharge your battery.
- Full Battery Operation:** You may also operate your **POWER PET™** Door with the battery only. This eliminates the need for the ac adapter or any electrical power connection. However, you will need to recharge the battery periodically. (Recharge interval varies depending upon use.) In this case, we recommend that you purchase the optional battery and a battery charger kit. With the charger kit you get a battery charger and an extra battery. Use one battery in your Power Pet door and keep the other in the charger. When your door battery runs low, just swap.

CONTROL PANEL

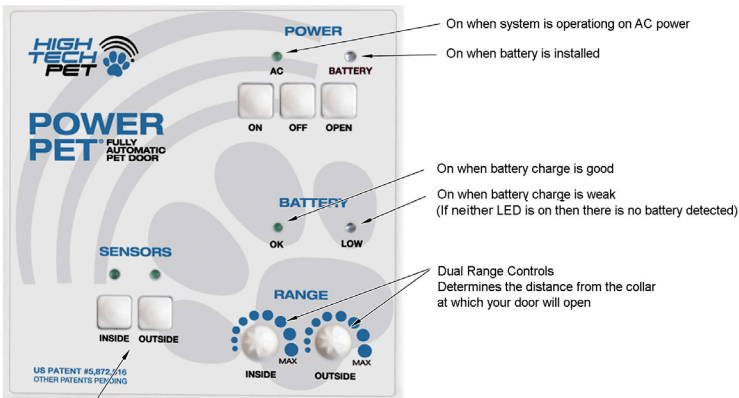

Sensor Controls
 LED indicates sensor is active
 Inside sensor allows pet to go outside
 Outside sensor allows pet to come inside

4 Way Access Control		
Sensors		Status
Inside	Outside	
On	On	Dog may go outside and come inside
On	Off	Dog may go outside but not come inside
Off	On	Dog may not go outside but may come inside
Off	Off	Door is closed and locked from inside and outside

4 WAY ACCESS CONTROL: Individual activation buttons for the inside and outside sensors give you a 4-way access control system. You can allow your pet to come in but not go out, go out but not come in, come in and out or close and lock the door altogether

DUAL RANGE CONTROLS: Individual range control to allow you to adjust different activation distances for inside and outside of your home. (Usually, it's a good idea to use a short inside distance of a foot or two and a longer 4 to 5 foot distance outside.) Your new Power Pet door gives you full control.

Normal setting of the range knob is between the markings 2nd and 4th dot. When you first install the Power Pet door set both range control knobs at about "3" and then while loosely holding the strap of the collar, move the hanging collar back and forth toward the door to determine the range at which it opens. Increase the knob position slightly to get longer range. Decrease the knob slightly to get shorter range. Just as your hearing of a conversation can be overpowered by loud noises such as a lawn mower, the door sensors can also be overpowered by loud ultrasonic noises. Specifically, some sprinklers, lawn mowers and vacuum cleaners can put out enough noise to temporarily mask the collar signal. The Power Pet door has a unique feature which indicates when the background noise level is too high. Whenever the INSIDE noise is too loud, the INSIDE light will flicker or flash on. This means you may want to decrease the INSIDE knob setting slightly. Whenever the OUTSIDE noise is too high, the OUTSIDE light will flicker or flash on. This means you may want to decrease slightly the OUTSIDE knob setting. A little flickering once in a while is normal. A lot of flickering or continuous flashing means the knobs is set too high.

AUTOMATIC CLOSE CONTROL: Your Power Pet door Features a smart sensing circuit that keeps the door panel open as long as it is receiving the signal from your pet's collar. Once your pet has moved completely through the opening, the panel immediately closes.

Adjust Hold-Up Time

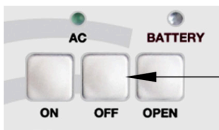

1. Press the Off Button

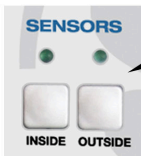

2. Press and hold sensor button(s) for at least 1 second according to the chart below:

Sensor Button		Hold-Up Time
Inside	Outside	
●		2 Seconds
	●	4 Seconds
●	●	6 Seconds

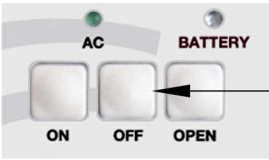

3. Press the Off Button again to save hold-up time.

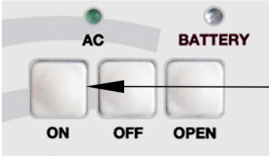

4. Press the On Button

HOLD OPEN FEATURE: If you wish to leave the door open for an extended time period, use the Hold Open Feature. This allows the doo remain open as long as power is available.

Enable Hold Open Feature

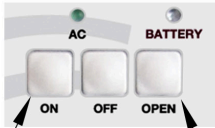

Hold the On Button Press the Open Button

Disable Hold Open Feature

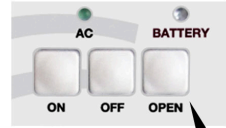

Press the Open Button

To return to normal operation just press the OPEN button.

To enable the feature, press and hold the ON button. Then press the OPEN button. Note that this feature requires motor is energized the entire time the door is open. So, if using only a battery to power the door, and you do not have an AC Power Adaptor plugged into the door, use this feature sparingly to keep from discharging the battery in just a few hours

AUTOMATIC SAFETY RETRACT: Your Power Pet door is intrinsically safe for all pets and people, including small children. The door panel weighs less than 2 lbs. and is closed smoothly by gravity (not the motor) and is too light to cause any physical injury. However, just to be doubly safe around infants, we've included an automatic safety retract feature. This feature causes the panel to instantly retract if it encounters an obstruction during closure.

Disable Auto Retract

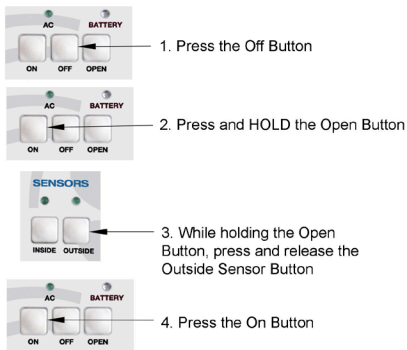

Enable Auto Retract

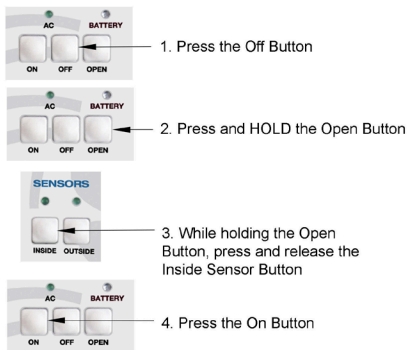

Disabling the Auto Retract Feature: Under unusual conditions, such as a warped wall mounting, the door sometimes may close so slowly that the auto-retract feature triggers the door to re-open unnecessarily. In these cases it may be desirable to defeat the Automatic Safety Retract feature. Do this by first pressing the OFF button to turn off the door controls and all the lights. Leave the door powered by the AC adapter or battery when you do this. Then while holding down the MANUAL OPEN button, press and release the OUTSIDE SENSOR button. The OUTSIDE light will blink to indicate the feature has been disabled.

Enabling the Auto Retract Feature: You may enable the Automatic Safety Retract feature at any time. Do this by first pressing the OFF button to turn off the door controls and all the lights. Leave the door powered by the AC adapter or battery when you do this. Then while holding down the MANUAL OPEN button, press and release the INSIDE SENSOR button. The INSIDE light will blink to indicate the feature has been enabled. Press the POWER ON button to resume normal door operation.

4. MS-5 ULTRASONIC PET COLLAR INSTRUCTIONS:

Fitting the MS-5 Electronic Collar on Your Dog

- Place the collar on your pet with the electronics at the throat as shown.
- When properly fitted, the receiver collar should not move on the dog, but also should not be overly tight. You should be able to fit your fingers between the strap and your pet's neck.

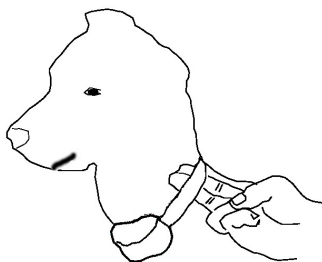

Note: The collar needs to be positioned on the bottom of your pet's neck, facing down, in order to trigger the door and barriers correctly.

Installing/Replacing the MS-5 Battery

NOTE: The B3V1A Battery (pictured right) is the ONLY battery that is compatible with the MS-5 collar. Do not attempt to use any other battery in the MS-5 collar.



NOTE: Some collars are shipped with a battery pre-installed. If the battery is not already pre-installed in the collar, install the battery by following these instructions.

1. *Unscrew the bottom cover.*

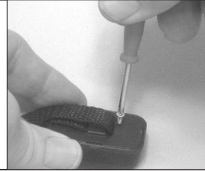

2. *Pry bottom off at the location shown here, using a small flat-blade screwdriver or metal nail file.*



3. *Remove bottom, note battery orientation*



4. *Remove and replace B3V1A battery*

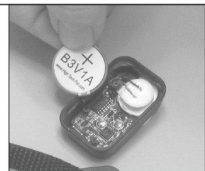

5. *With new battery installed, close case. Squeeze until bottom flush with top, by squeezing top and bottom together*



6. *Insert and tighten screw.*



5. TROUBLESHOOTING GUIDE:

Your Power Pet door comes with a full one-year repair/ replacement warranty. It's designed and built to last a lifetime. However, should you encounter a failure after your warranty has expired, here are some useful troubleshooting tips.

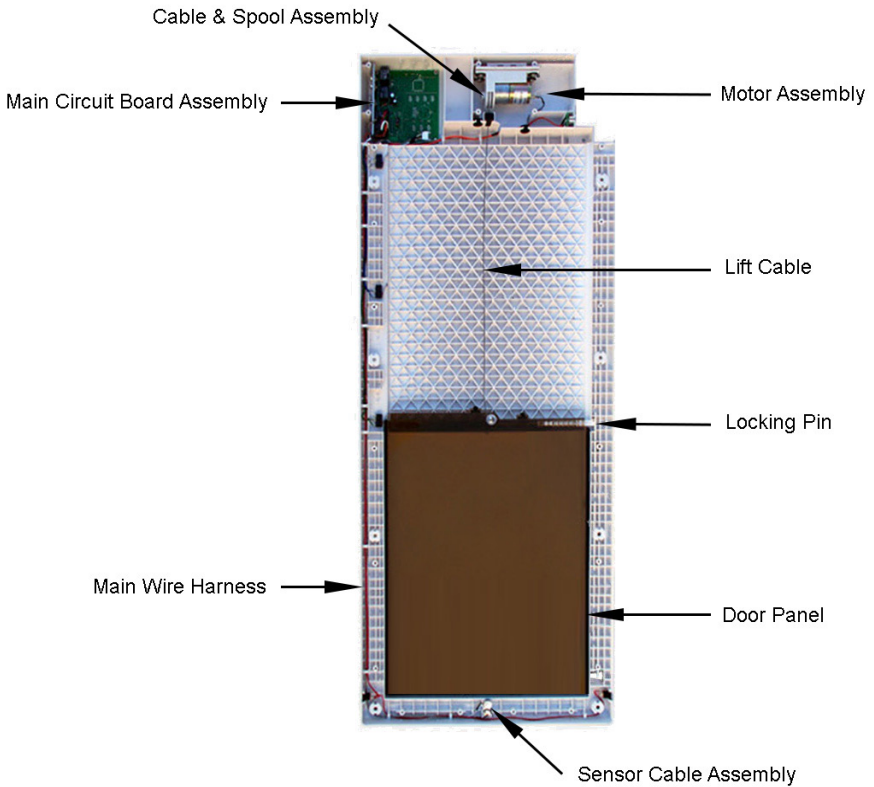

POWER PET DOOR TROUBLE SHOOTING GUIDE

Failure	Possible Solution
Door panel goes up and down without stopping	Slightly loosen pet door mounting screws Replace Main Wire Harness Replace Main Circuit Board
Very short range on one or both sensors	Replace Sensor Cable Replace Main Circuit Board
Manual button works but door is not triggered by collar	Replace Collar Replace Sensor Cable Replace Main Circuit Board
Door goes up too slowly	Replace Motor Assembly Replace Main Circuit Board
Door sticks at top	Replace Motor Assembly Replace Main Circuit Board
Door seems to sometimes open by itself	Reduce range settings on front panel
Door does not open with manual button or collars	Replace Main Circuit Board
Range is Difficult to adjust to less than 5 feet	Replace Main Circuit Board
Collar light does not operate or collar does not open door	Replace Battery with High Tech Pet Model B-3V1A Replace Collar

6. ACCESSORIES:

Extra MS-5 Ultrasonic Collar:



Digital circuitry in this state of the art design provides a strong signal and maintains accuracy over all temperature ranges. It is extra rugged so it won't get damaged during your dog's "ruffhousing". With a robust, fully enclosed ultrasonic transducer speaker, it is immersible to 6ft., and although we don't recommend immersing your dog in 6 ft. of water without scuba gear, the collar will stay high and dry! The MS-5 uses our specially designed B-3V1A battery which lasts about 3 months and prevents damage to the circuitry if the battery is installed incorrectly.

Model: MS-5 Replacement Battery: Model: B-3V1A



Pet Door Battery & Charger Kit: Model CRG-12V-2P



Operating your POWER PET™ Door is most convenient in full battery mode. This eliminates the need for the 110 volt ac adapter. This kit includes a charger and 2 rechargeable batteries. Use one battery in your POWER PET™ Door and keep the other in the charger base. When your pet door battery runs low, just swap. Battery change takes less than 30 seconds!

Aluminum Wall Tunnel: Medium: Model AW-PX1 Large: Model AW-PX2



Quickly, Easily and Professionally frame your large Power Pet Door wall installation with our pre made Wall Adapter Tunnel. Professional looking wall installation is easy with your pre-fabricated Wall Adapter Tunnel. Your Model WA-2 Wall Adapter Tunnel eliminates the need for difficult framing of the hole you cut in your wall for the pet door passage way. Made of heavy gauge aluminum with a super tough industrial powder coat finish.