



[In the US]
**PLEASE - BEFORE RETURNING TO STORE,
CONTACT HUFFY CUSTOMER SERVICE. WE
ARE GLAD TO ASSIST YOU WITH ANY PARTS
OR ASSEMBLY PROBLEMS YOU MIGHT
HAVE!**

For Fast Customer Service, go to:

<http://www.huffybikes.com/contact>

To Order Parts (US only), go to:

<http://www.huffybikes.com/parts>
OR TEL: 1 800 872 2453 (US only)

For email, go to <http://www.huffybikes.com/contact>

[CANADA]

**VEUILLEZ NOTER : AVANT DE
RETOURNER AU MAGASIN,
COMMUNIQUEZ AVEC LE SERVICE
À LA CLIENTÈLE DE HUFFY. NOUS
VOUS AIDERONS VOLONTIERS AVEC
TOUT PROBLÈME CONCERNANT LES
PIÈCES OU LE MONTAGE!**

Pour un Service à la clientèle rapide, allez sur le
site :

<http://www.huffybikes.com/contact>

To Order Parts (CANADA only), go to:

<http://www.huffybikes.com/parts>

OU appelez le 1 800 872 2453
(CANADA only)

Pour communiquer par courriel
huffycanada@huffy.com

Check <http://www.huffybikes.com/home/globalcontact>
for the current contact information

<http://www.huffybikes.com/home/globalcontact>
para obtener la información de contacto actual

Vérifier <http://www.huffybikes.com/home/globalcontact>
pour les informations de contact actuelles

[MÉXICO]

**ANTES DE DEVOLVER EL
PRODUCTO A LA TIENDA,
COMUNÍQUESE CON SERVICIO
AL CLIENTE DE HUFFY. NOS
COMPLACE AYUDARLO CON
CUALQUIER PARTE O PROBLEMA
DE ENSAMBLADO QUE PUDIERA
TENER.**

Para obtener Servicio al cliente rápido, visite:

<http://www.huffybikes.com/>

○ LLAME AL TEL: 01800 1483 391
(Mexico only)

Para comunicarse por correo electrónico:
servicio@huffymex.com



HUFFY

H-Tri_STOP-Global_022217_i0388



Date Code Label
Here

H-LMC Rideon EN 060717 m0409
© Copyright Huffy Corporation 2017

Owner's Manual for Battery Ride On



**This manual contains important safety, assembly, operation and
maintenance information.**

**Please read and fully understand this manual
before operation.**

Save this manual for future reference.

**See back page for Customer Service Information
Consulte el reverso para Servicio de Información al Cliente
Voir pages verso pour des renseignements le service à la clientèle**

Owner's Manual Index

NOTES:

Safety

- User and Battery Warnings.....3-4
- Radio Frequency4
- Charging Drive Motor Warnings.....5

Assembly

- Parts Assembly.....6-7
- Introduction to Assembly and Tools Needed8
- Charging Port Location.....8
- Vehicle Assembly9-14
- Attaching the Battery and Installing the Seat15

Operation

- How to Operate your Vehicle.....16

Maintenance Repair and Service

- General17
- Battery Storage, Replacement and Disposal.....18
- Battery Fuse and Recharge Time.....19

Troubleshooting 20-21

Warranty

- Limited Warranty.....22

Contact Information..... Back Cover

WARNING: CHOKING HAZARD:

- Small parts, adult assembly required.
- To reduce the risk of injury, adult supervision is required.
- Never use in roadways, near motor vehicles, on or near steep inclines or steps, swimming pools or other bodies of water; always wear shoes, and never allow more than one rider.
- The user must be **3+ years**, and weigh no more than **65 lbs (30kgs)**.



IMPORTANT! Before using the unit for the first time the battery needs to be charged for at least **8 to 12** hours - no more than **20** hours. Only an adult who has read and understands the safety warnings should handle, charge or recharge of the battery (see Maintenance).

Limited Warranty

General:

- Part or model specifications are subject to change without notice.
- This Limited Warranty is the only warranty for the product. There are no other express warranties.
- The only uses for this product are described in this manual.
- Warranty registration is not required.
- The Limited Warranty extends only to the original consumer and is not transferable to anyone else.

What does this Limited Warranty cover?

This Limited Warranty covers all parts of the product except those indicated below as not warranted.

What must you do to keep the Limited Warranty in effect?

This Limited Warranty is effective only if:

- Product is completely and correctly assembled.
- Product is used under normal conditions for its intended purpose (see the following section for excluded activities).
- Product receives all necessary maintenance and adjustments.
- Product is used for general transportation and recreational use only.

What is not covered by this Limited Warranty?

This product is designed for recreational use only. This Limited Warranty does not cover normal wear and tear, normal maintenance items, or any damage, failure, or loss that is caused by improper assembly, maintenance, adjustment, storage, or use of the product.

This Limited Warranty will be void if the product is ever:

- Used in any competitive sport
- Used for stunt riding, jumping, aerobatics or similar activity
- Modified in any way
- Modified with the addition of a motor
- Ridden by more than one person at a time
- Rented, sold, or given away

- Used in a manner contrary to the instructions and warnings in this Owner's Manual

Huffy will not be liable for incidental or consequential loss or damage due directly or indirectly from use of this product. Some States do not allow the exclusion or limitation of incidental or consequential damages, so the above limitation may not apply to you.

What will Huffy do?

Huffy will replace, without charge to you, any part, or component found to be defective by Huffy.

How do you get service?

Contact the Customer Service Department.

- See included list for Customer Contact information or visit www.huffybikes.com/ contact.

What rights do you have?

This warranty gives you specific legal rights. You may also have other rights which vary from State to State.

How long does this Limited Warranty Last?

- Drive Battery - 30 days
- Electronics - 90 days
- All other Components - 6 months
- All parts are subject to the Conditions of Warranty below.

This product meets ASTM F963 and CPSIA requirements for electric vehicles.



WARNINGS

Here are basic, common sense safe riding practices you should read aloud to your child and anyone who may use the vehicle.

It is the responsibility of the adult to educate the child, determine if they are fit to operate the vehicle, and supervise use.

- An adult must always supervise a child that is using the vehicle.
- Before using the vehicle the user must understand the controls and safety issues. They must also demonstrate the capability to handle the vehicle and operate its controls.
- Always sit in the seat when using the vehicle. Do not stand on side boards.
- This product contains small parts that are for adult assembly only. Keep small children away when assembling. Remove and dispose of all protective material and poly bags before assembly. Be sure to remove all packaging materials and parts from underneath the vehicle body.
- Always use the vehicle in a safe, secure environment with continuous adult supervision.
- Body parts such as hands, legs, hair and clothing can get caught in moving parts. Never place a body part near a moving part or wear loose clothing while using the vehicle. Always wear shoes when using vehicle.
- Use on flat, smooth paved surfaces only.
- Using the vehicle on or near streets, motor vehicle, drop-offs such as: steps, water (swimming pools), sloped surfaces, hills, wet areas, flammable vapors, in alleys, at night or in the dark could result in an accident.
- Do not use the vehicle in unsafe conditions such as snow, rain, loose dirt, mud sand or fine gravel. This may result in unexpected action such as tip over and skidding.
- Models with no brakes: Motor friction will gradually stop the unit.
- Do not use the vehicle in an unsafe manner. Examples include but are not limited to:
 - Pulling the vehicle with another vehicle or similar device.
 - Allowing more than one rider.
 - Pushing the vehicle.
 - Traveling at an unsafe speed.
- There are additional hazards of using the vehicle in areas other than private grounds.
- Not to be used in traffic.
- The vehicle shall be used with caution since skill is required to avoid falls or collisions.
- Do not overload the vehicle.
- Do not tow anything behind the vehicle.
- Do not drive up steep slopes.
- Do not drive into fixed objects, which may cause the wheels to spin, causing the motor to overheat.
- Do not drive in very hot weather, components may overheat.
- Do not allow water or other liquids to come in contact with the battery or other electric components.
- Do not tamper with the electrical system. Doing so may create a short, causing the fuse to trip or other damage including fire.
- Do not stand on or in vehicle while moving.
- Child should always wear an approved helmet when using this product.
- If equipped, child should always use properly and securely attached Seat Belt.
- Only use authorised replacement parts.

Helmet Warning Information

! WARNING:
ALWAYS WEAR YOUR HELMET WHEN RIDING THIS PRODUCT!

- Helmet should sit level on your head and low on your forehead. Exposed forehead can result in serious injury.
- Adjust the strap sliders below the ear on both sides.
- Buckle the chin strap. Adjust strap until it is snug.
- No more than two fingers should fit between the strap and your chin.
- A proper fitting helmet should be comfortable and not rock forward/backward or side to side.

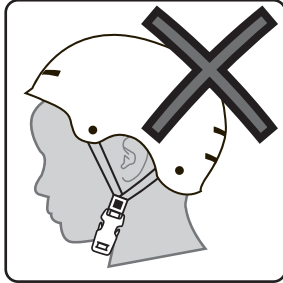
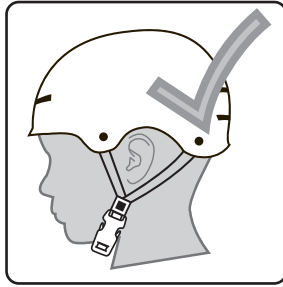

Radio Frequency Information (charger/adapter)

! CAUTION: Changes or modifications to this unit not expressly approved by the party responsible for compliance could void the user's authority to operate the equipment.

This device (charger/adapter) complies with Part 15 of the FCC Rules. Operation is subject to the following two conditions:

- (1) this device may not cause harmful interference, and
- (2) this device must accept any interference received, including interference that may cause undesired operation.

NOTE: This equipment has been tested and found to comply with the limits for a Class B digital device, pursuant to Part 15 of the FCC Rules. These limits are designed to provide reasonable protection against harmful interference in a residential installation. This equipment generates, uses and can radiate

radio frequency energy and, if not installed and used in accordance with the instructions, may cause harmful interference to radio communications.

However, there is no guarantee that interference will not occur in a particular installation. If this equipment does cause harmful interference to radio or television reception, which can be determined by turning the equipment off and on, the user is encouraged to try to correct the interference by one or more of the following measures:

- Reorient or relocate the receiving antenna.
- Increase the separation between the equipment and receiver.
- Connect the equipment into an outlet on a circuit different from that to which the receiver is connected.
- Consult the dealer or an experienced radio/TV technician for help.

Troubleshooting Guide - continued

Problem	Possible Cause	Solution
Vehicle will not run when Switch is pressed.	Poor contact of wires or connectors	Check that the battery connectors are firmly plugged into each other. If wires are loose around the motor call Customer Service.
	"Dead Spot" on motor	A dead spot means the electric power is not being delivered to the terminal connection and the vehicle needs repair. Call Customer Service.
Loud grinding or clicking noises coming from motor or gear box	Motor or gears are damaged	Call Customer Service.
	Drive Wheel is partially engaged	Check drive wheel - to motor engagement.
Battery will not recharge	Battery connector or adapter connector is loose	Check that the battery connectors are firmly plugged into each other.
	Charger not plugged in	
	Charger is not working	Check that the battery charger is plugged into a working wall outlet.
Charger feels warm when recharging	Battery is dead	Replace battery.
	This is normal and not a cause for concern	If excessively hot, unplug and replace.

Troubleshooting Guide

The following are examples of potential problems. Completely read through this manual and the troubleshooting guide table before calling. If you still need help resolving the problem please contact Customer Service.

NOTE: Vehicle should be turned off and fully charged before doing troubleshooting.

Problem	Possible Cause	Solution
Vehicle does not run	Battery low on power	Recharge battery (see Battery: Recharge interval and time)
	Thermal fuse has tripped	Let Fuse reset
	Battery connector or wires are loose	Check that the battery connectors are firmly plugged into each other. If wires are loose around the motor call Customer Service.
	Battery is dead	Replace battery (see Battery: Replacement and Disposal)
	Electrical system or motor is damaged	Call Customer Service.
Vehicle does not run very long	Battery is undercharged.	Check that the battery connectors are firmly plugged into each other when recharging (see Battery: Recharge interval and Time)
	Battery is old and cannot be fully charged	Replace battery (see Battery: Replacement and Disposal)
Vehicle runs sluggishly	Battery low on power	Recharge battery (see Battery: Replacement and Disposal)
	Battery is old and cannot be fully charged	Replace battery (see Battery: Replacement and Disposal)
	Vehicle is overloaded	Reduce weight on vehicle (see user requirements and Safety Warnings)
	Vehicle is being used in harsh conditions	Avoid using vehicle in harsh conditions (see User Requirements and Safety Warnings)
Vehicle makes loud noise when in use	Chain is dry (on chain drive models)	Lubricate chain with light oil.

WARNING - Charging the Drive Motor Battery

The following safety hazards may result in serious injury or death to the user of the vehicle:



- Use of a battery or charger other than the supplied rechargeable battery and charger may cause a fire or explosion. Only use the supplied rechargeable battery (or suitable replacement) and charger with the vehicle.
- Using the rechargeable battery and charger for any other product may result in overheating, fire or explosion. Never use the rechargeable battery and charger with another product.
- Explosion. Gases are created during charging. Charge the battery in a well ventilated area. Do not charge the battery near heat or flammable materials.
- Contact between the positive and negative terminals may result in fire or explosion. Avoid direct contact between the terminals. Picking up the battery by the wires or charger can cause damage to the battery and may result in a fire. Always pick up the battery by its case or handles.
- Battery must be handled by adults only. Liquids on the battery may cause fire or electric shock. Always keep all liquids away from the battery and keep the battery dry.
- Contact or exposure to battery leakage (lead acid) may cause serious injury. If contact or exposure occurs immediately call your physician. If the chemical is on the skin or in the eyes, flush with cool water for 15 minutes. If the chemical was swallowed, immediately give the person water or milk. Do not give water or milk if the patient is vomiting or has a decreased level of alertness. Do not induce vomiting.
- Battery Posts, terminals and related accessories contain lead and lead compounds (acid), chemicals known to cause cancer, reproductive harm and are toxic and corrosive. Never open the battery.
- Tampering or modifying the electric circuit system may cause a shock, fire or explosion and permanently damage the system. Exposed wiring and circuitry in the charger may cause electric shock. Always keep the charger housing closed.

Important! Before using the unit for the first time the battery needs to be charged for **8 to 12 hours - never longer than 20 hours**. Only an adult who has read and understands the safety warnings should handle, charge or recharge of the battery (see Maintenance).

NOTE: It is not necessary to remove the battery from the vehicle for charging.

continued >>

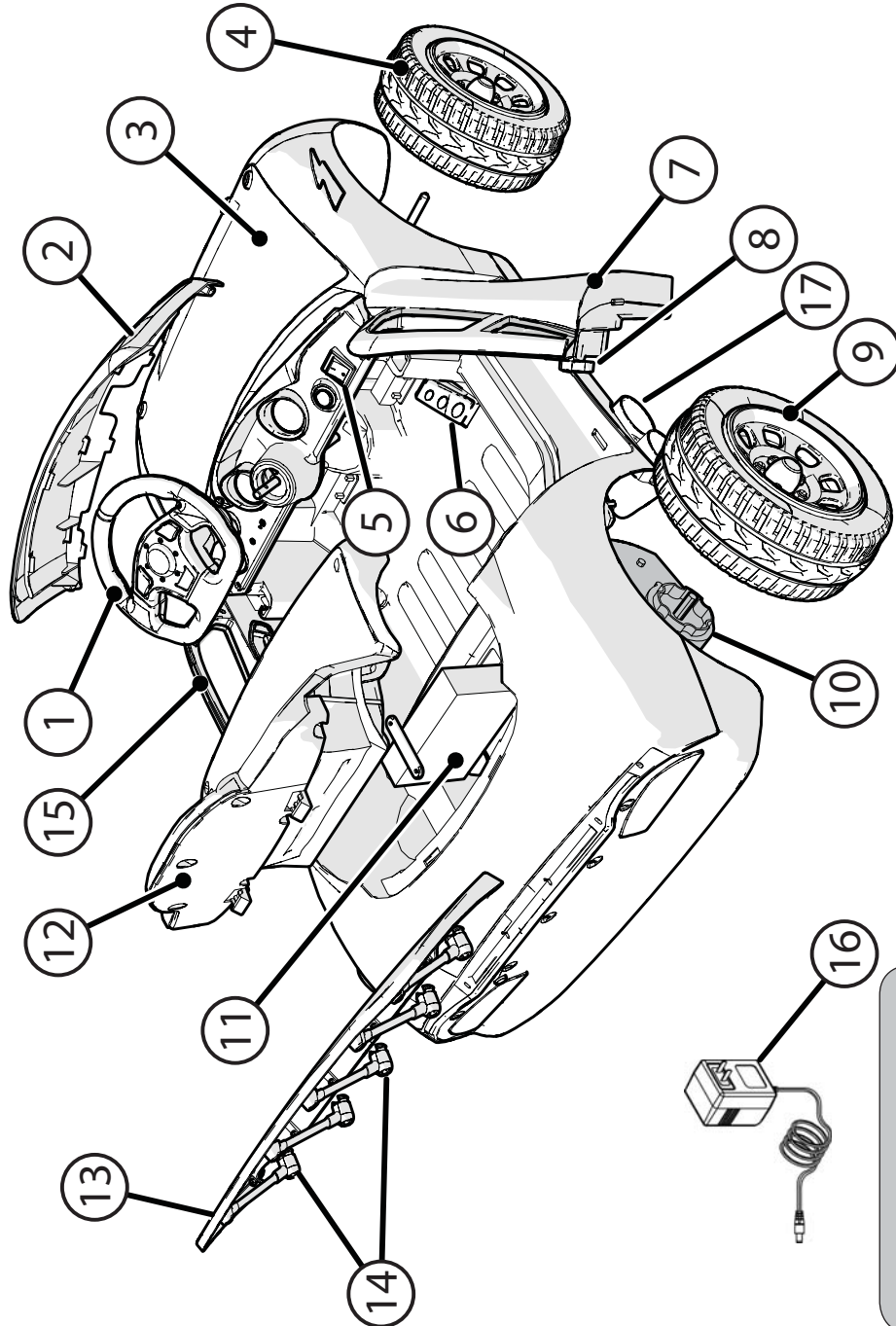

NOTE: All features, components and accessories are not included on all models.

Drive Motor Battery

Only an adult who has read and understands the safety warnings should handle, charge or recharge the battery. Failure to comply with all safety warnings may result in serious injury or death.

Battery Fuse

The drive motor circuit features a thermal fuse that will automatically trip and cut all power to the vehicle if the motor, electric system or battery is overloaded. The fuse will reset and power will be restored after a short time. If the thermal fuse trips repeatedly during normal use, the vehicle may need repair.

DO NOT BYPASS THE FUSE - RISK OF FIRE. This may overload and damage the electrical system.

Battery Re-charge Interval and Time

IMPORTANT!

Check the drive battery and charger (supply cord, connector) for wear and damage before charging. Do not charge the battery if damage has occurred. Only replace with the same type and voltage rechargeable battery and charger supplied by the manufacturer.

- Only use the rechargeable battery (or equivalent replacement) and charger supplied with your vehicle.
- Before first use, charge battery **8 to 12 hours - never longer than 20 hours.**
- Once battery is depleted, recharge for **8 to 12 hours - never longer than 20 hours.**
- Do not short circuit the battery: Do NOT connect red and black wires together or connect positive and negative terminals on the battery together.
- When battery is fully charged, un-plug charger from the wall outlet and disconnect from charger port.

The drive battery should be charged when depleted, or if not used regularly, once a month. Failure to charge the battery as directed will cause permanent damage to the battery and will void the warranty.

Battery Storage and Disposal

The drive battery should be charged when depleted, or if not used regularly, once a month. Failure to charge the battery as directed will cause permanent damage to the battery and will void the warranty.

Follow these guidelines if the battery is removed:

- Do not store battery in extreme hot or cold temperatures.
- Wipe the battery clean with a dry cloth prior to storage. Wash cloth separate from other clothes.

BATTERY DISPOSAL:

- The sealed lead-acid battery must be re-

cycled or disposed of in an environmentally sound manner.

- Do not dispose of battery in a fire. The battery may explode or leak acid.
- Do not dispose of the battery in household trash. The incineration, land filling or mixing of sealed lead-acid batteries with household trash is prohibited by law.
- Return an exhausted battery to a federal or state approved lead-acid battery recycler, such as a local seller of automotive batteries (check local battery disposal regulations).

Parts List

#	Description	#	Description
1	Steering Wheel	9	Drive Wheel
2	Windshield	10	Drive Motor
3	Vehicle body	11	Drive Battery
4	Free Spin Wheels:	12	Seat
	• Right Front (x1)	13	Rear Spoiler, Screws (x6)
	• Left Front/Left Rear (x2)	14	Spoiler Stabilizer (x5), Screws (x5)
5	Forward/Reverse Direction Switch	15	Door LH and Mounting Screw
6	Foot Switch	16	Battery Charger
7	Door RH and Mounting Screw	17	Exhaust Pipes (left and right)
8	Door Lock Knob (x2)		

Introduction to Assembly

This Owner's Manual may be made for several different style products.

- Some illustrations may vary slightly from the actual product.
- Follow instructions completely.
- If the product has any parts that are not described in this manual, look for separate "Special Instructions" that are supplied with the unit.
- All features, components and accessories are not included on all models.
- Use the Index page to locate specific sections of this manual.
- Please read through this entire manual before beginning assembly or maintenance.
- If you are not confident with assembling this unit, contact customer service.

WARNING: Keep small parts away from children during assembly.

NOTE: All of the directions (right, left, front, rear, etc.) in this manual are as seen by the rider while seated.

Do not dispose of the carton and packaging until you complete the assembly of the product. This can prevent accidentally discarding parts of the unit.

Tools Needed

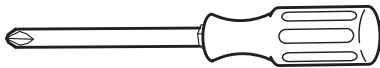

Phillips Screwdriver

CHARGING PORT LOCATION:

NOTE: Charging Port **A** is located below the front edge of the Seat.

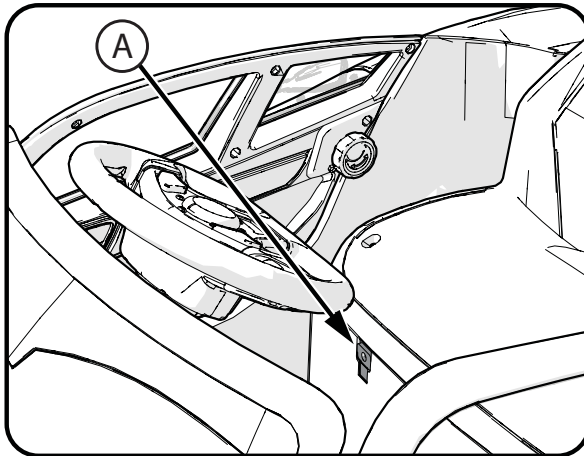

Maintenance Repair and Service

General: The vehicle should be checked for damage, missing or badly worn parts before each use. If any part of the product does not operate properly – discontinue use.

- Check the tightness of the fasteners before each use. Replace any fasteners that are damaged.
- Inspect the product frequently. Failure to inspect the product and to make repairs or adjustments, as necessary, can result in injury to the rider or to others. Make sure all parts are correctly assembled and adjusted as written in this manual and any "Special Instructions".
- Immediately replace any damaged, missing, or badly worn parts.
- Make sure all fasteners are correctly tightened as written in this manual and any "Special Instructions". Parts that are not tight enough can be lost or operate poorly. Over tightened parts can be damaged. Make sure any replacement fasteners are the correct size and type.
- Check the tightness of the wheels:

Note: If the drive wheel is not tight, it will not engage the gears and the vehicle will not run.

- Ensure the battery bracket is securely in place before use.
- Store the vehicle indoors. Keep it away from sources of heat, such as stoves and heaters.
- Keep the product clean and free of dirt, dust and water. This will prolong the useful life of the product.
- Clean the vehicle with a soft, dry cloth. To restore shine to plastic parts, use a non-wax furniture polish. Do not use automotive wax, abrasive cleaners or wash the vehicle with soap and water.

WARNING: Water will damage the motor, electrical system and battery.

NOTE: If the instructions in this manual or any "Special Instructions" are not sufficient for you, please contact customer service.

How to Operate the Unit

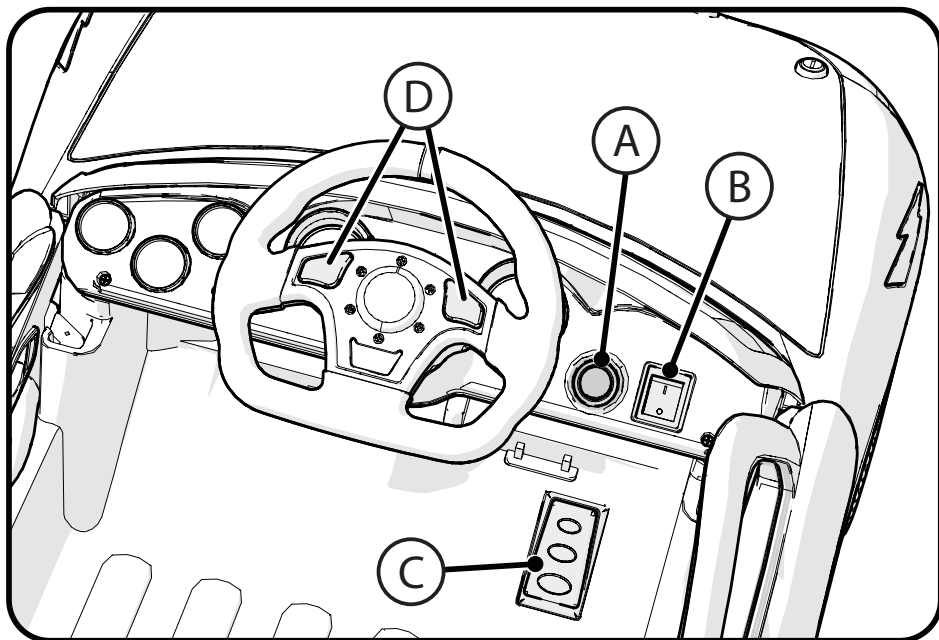

OPERATION (make sure child understands these instructions):

- Press the Power Switch button (A) to turn unit **ON**. Sounds and fender lightening bolts light.
- Move the Direction Switch (B) to FORWARD to go **FORWARD** when the Foot Switch (C) is pressed. Headlights will light.
- Move the Direction Switch (B) to REVERSE to go **BACKWARDS** when the Foot Switch (C) is pressed. (Headlights do NOT light)
- Release Foot Switch (C) to **STOP**.
- Press the Power Switch button (A) again to turn unit **OFF**.

LIGHTS AND SOUNDS:

- Press Sound Buttons (D) to play sounds. Fender lightening bolts also light.

Installing the Front Wheels:

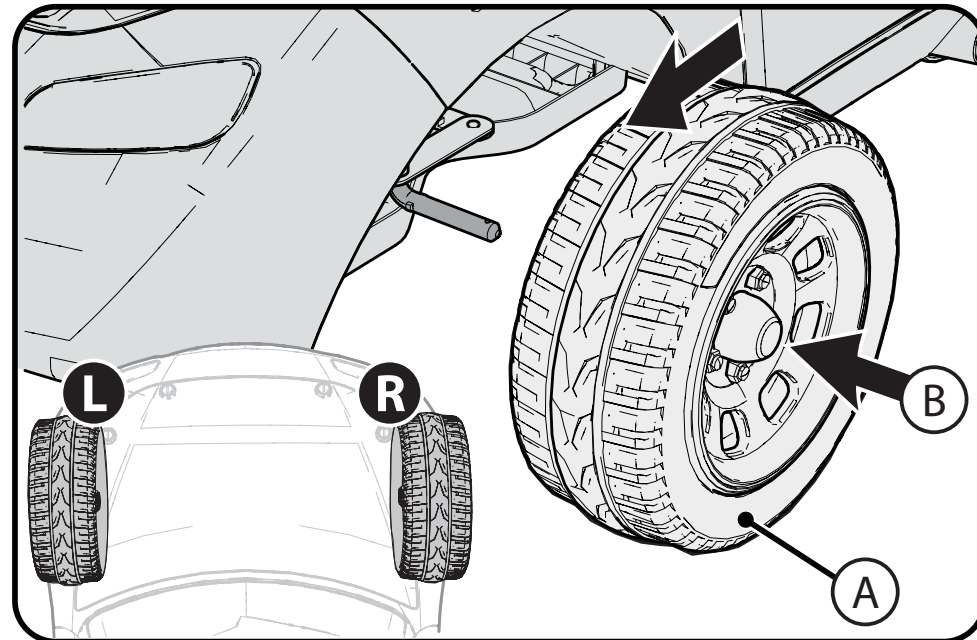

NOTE: Install wheel marked **L** on Left and wheel marked **R** on Right and with center tread pointing **FORWARD** - looking from the top.

1. Attach both front 'free spinning' Wheels (A) by fitting Wheels fully onto the Axle while pushing on the center hub-cap Button (B) until the wheels SNAP into place.

Check that wheels are fully snapped in place by gently pulling outward.

Installing the Left-Rear Wheel:

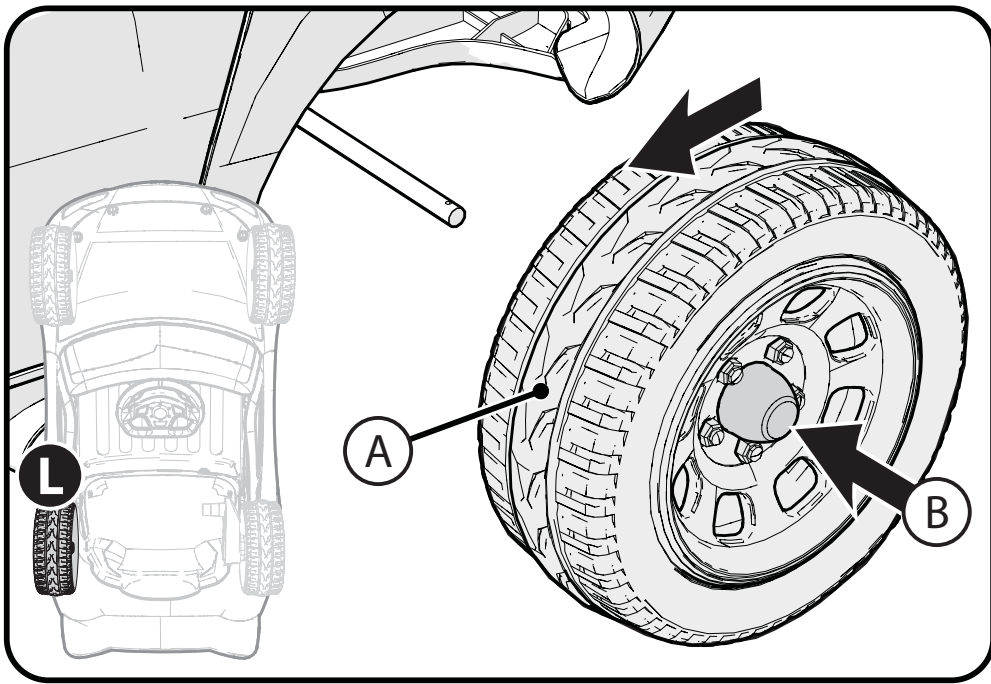

NOTE: Install Wheel marked **L** on Left with center tread pointing FORWARD - looking from the top.

1. Attach the left rear 'free spinning' Wheel **(A)** by fitting Wheel fully onto the Axle while pushing on the center hub-cap Button **(B)** until the wheel SNAPS into place.

Check that wheels are fully snapped in place by gently pulling outward.

NOTE: SNAP both Rear Wheels on at the same time.



Connect Battery and Install Seat:

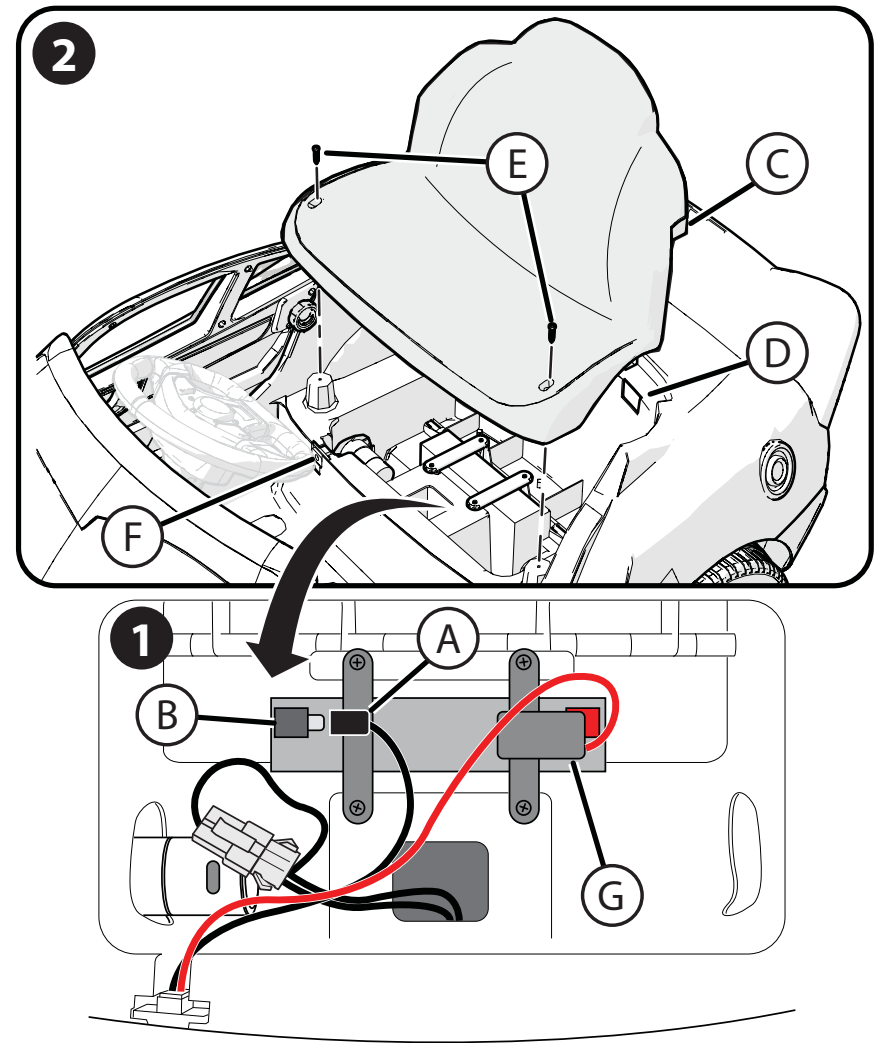

STEP 1 Connect Battery:

- Attach **BLACK** Battery Connector **(A)** to Battery Terminal **(B)** firmly and completely.

STEP 2 Install Seat (OPEN BOTH DOORS):

- Tilt back Seat slightly and insert back 2 Seat Tabs **(C)** into 2 Slots **(D)**.
- With Tabs firmly seated, tilt Seat forward until fully seated.
- Install two Screws **(E)** fully and securely. Do not over-tighten. This can damage the unit.

NOTES:

- Battery **Charging Port** **(F)** is below front edge of seat.
- **Thermal Fuse** **(G)**.

Install the Spoiler:

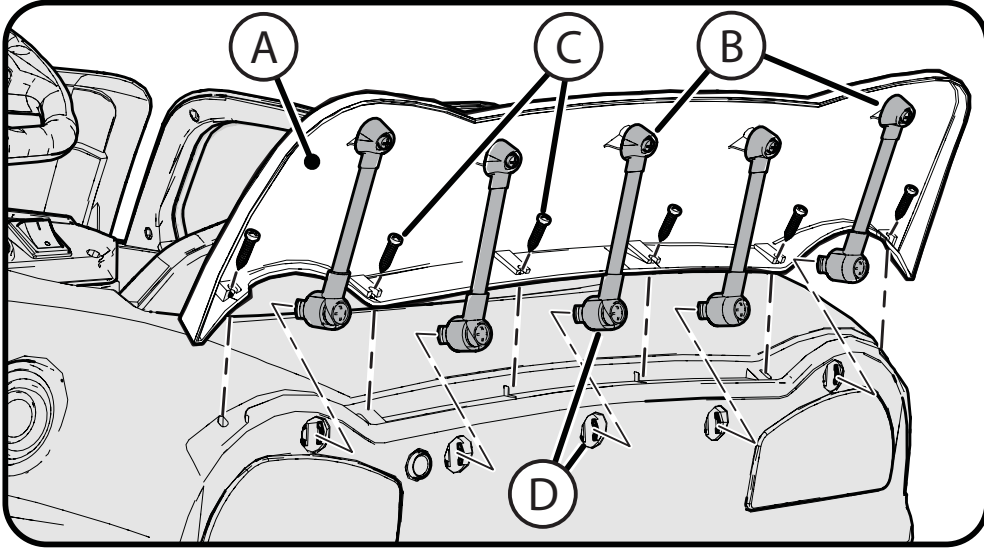

STEP 1:

- Position Spoiler (A) with Stabilizers (B) to the rear as shown.
- Line up Spoiler Mounting Holes and install 6 Screws (C) loosely.

STEP 2:

- Insert bottom of each Stabilizer (B) until they SNAP into position in Mounting Holes (D).
- Tighten the 6 Screws (C) evenly and securely. Do not over-tighten.

Install the Exhaust Pipes:

NOTE: Exhaust Pipes are marked with an **L** and **R** for each side.

- Install the left Exhaust Pipe (A) on the left side by lining up the tabs on the body (B) and snapping firmly into place.
- Repeat for opposite side.

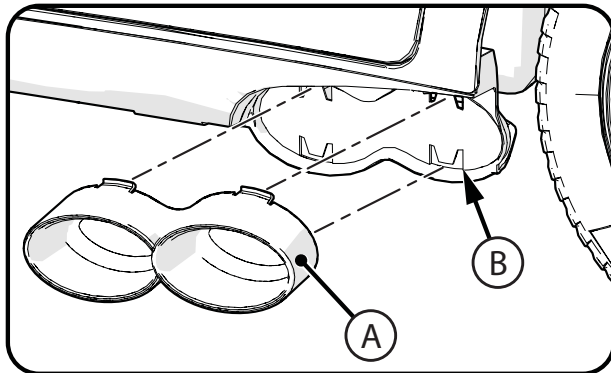

Installing the Rear DRIVE Wheel:

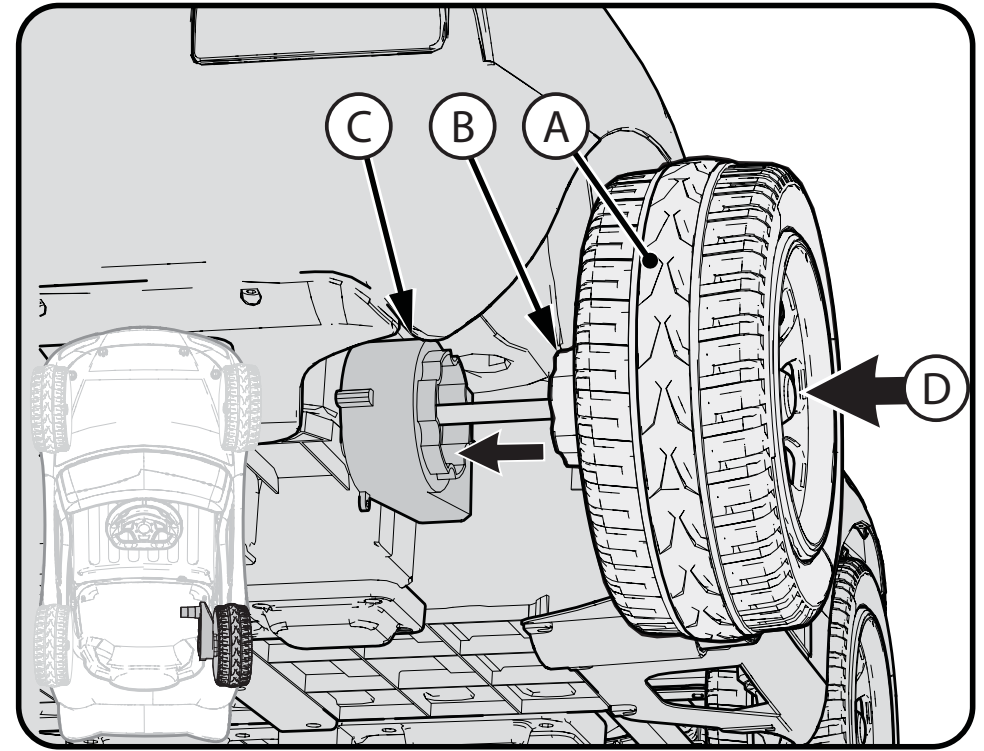

Installing the DRIVE Wheel:

NOTE: Fully push in on the LEFT Wheel while installing the Right Wheel.

1. Attach rear Drive Wheel (A) by fitting Wheel fully onto the Axle and making sure Notches (B) align with Motor (C), then pushing on the center hub-cap Button (D) until the wheel SNAPS into place.

Check that Drive Wheel is fully snapped in place by gently pulling outward.



Install Steering Wheel:

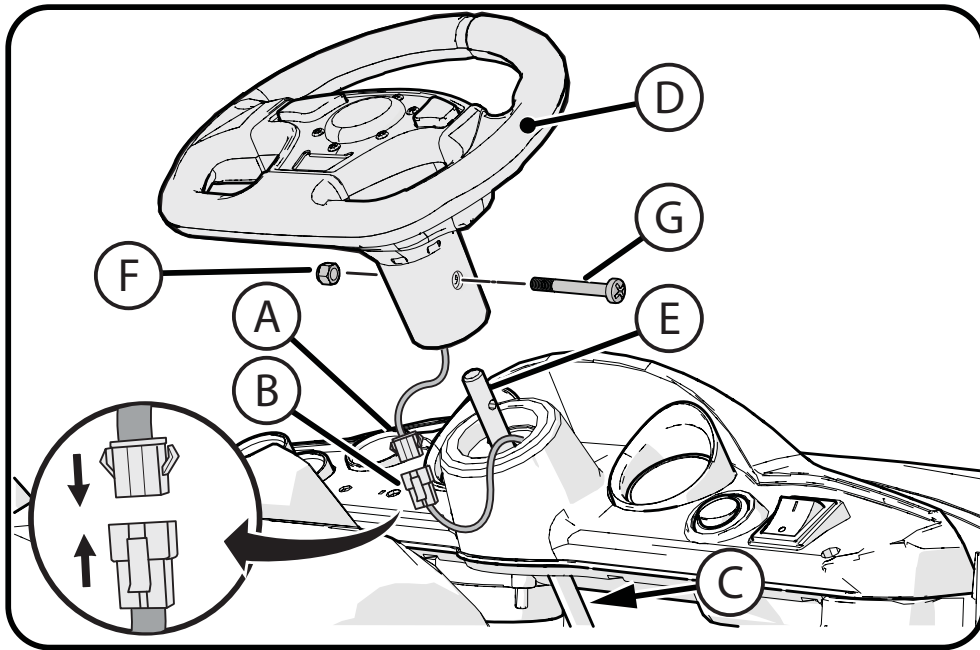

STEP 1:

- Remove Screw (G) and Locknut (F) from steering wheel if pre-installed.
- With Steering Wheel facing forward, firmly connect the steering wheel Connector (A) to the Plug extending out of the car body hole (B).

CAUTION: Put the connected plugs down into the car body hole so that Steering wheel attaches easily and wires are not pinched or bound up.

STEP 2:
(While pulling UP on Steering Rod (C)):

- Install the Steering Wheel (D) onto the Steering Rod end (E) so that all Mount Holes line up.
- Install the Screw (G) and Locknut (F) as shown.
- Tighten Screw (G) securely.

CAUTION: Ensure Steering Wheel turns freely from side to side without binding and that front wheels turn.

Install the Doors:

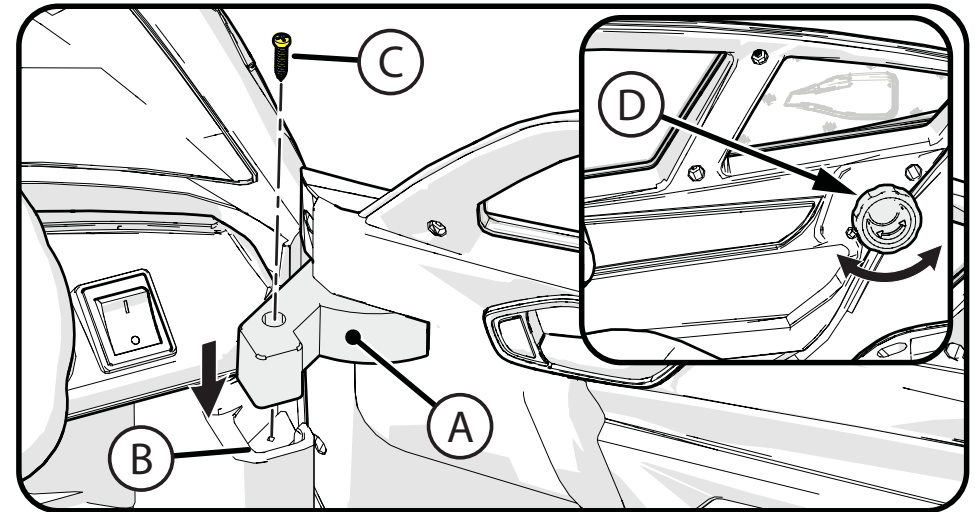

STEPS:

1. Position Door Hinge (A) into car body Recess (B).
2. Install mounting Screw (C) securely. Do not over-tighten. This can damage the mount.
3. Repeat for opposite side.
4. Ensure doors close correctly and Door Locks (D) hold the doors shut when turned towards the REAR as shown.

Install the Windshield:

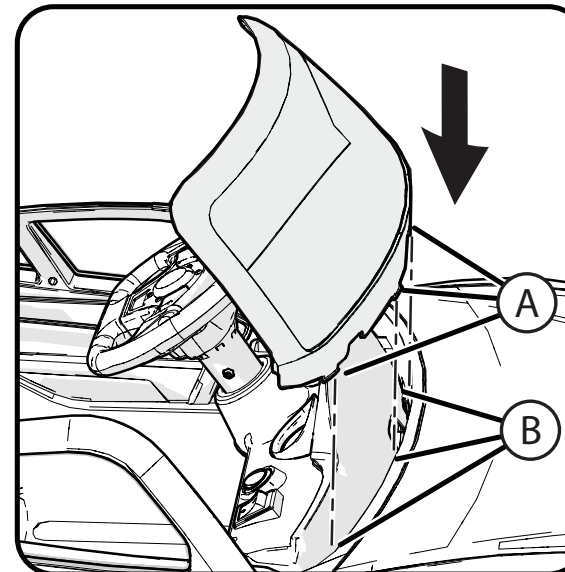

STEPS:

1. Fit the Windshield Tabs (A) into the recess Holes (B) and snap into position evenly and securely.
2. Test by pulling up slightly. Windshield should not pull out easily.